

夹持具 E
ACCESSORIES





BT-ER 弹性刀柄
BT-ER Collet chuck



材质为特殊合金钢
硬度为65±1HRC

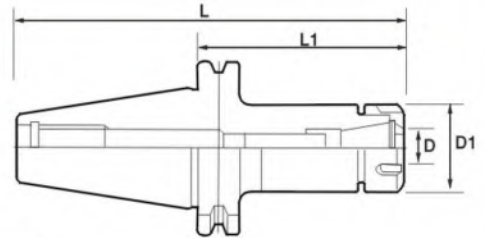

型号说明 Model explanation

BT40 ER 20 70

刀柄形状

夹头略号

从基准面开始的长度

最大把握直径

● 设计简单方便，精度高。

● Designs simply convenient, the precision is high.

型号 Cat.No	尺寸 Size				筒夹 suitable collet	扳手 suitable spanner	重量 Weight (KG)	
	D	D1	L1	L				
BT30	-ER11-70	11	19	70	118.4	ER11	ER11A-BS	0.45
	-ER11-100	11	19	100	148.4	ER11	ER11A-BS	0.55
	-ER16-70	16	28	70	118.4	ER16	ER16A-BS	0.55
	-ER16-100	16	28	100	148.4	ER16	ER16A-BS	0.80
	-ER20-70	20	34	70	118.4	ER20	ER20A-BS	0.75
	-ER20-100	20	34	100	148.4	ER20	ER20A-BS	0.85
	-ER25-70	25	42	70	118.4	ER25	ER25UM-BS	0.70
	-ER25-100	25	42	100	148.4	ER25	ER25UM-BS	1.45
	-ER32-70	32	50	70	118.4	ER32	ER32UM-BS	0.95
	-ER32-100	32	50	100	148.4	ER32	ER32UM-BS	1.05
	-ER40-80	40	63	80	128.4	ER40	ER40UM-BS	1.20
BT40	-ER11-70	11	19	70	135.4	ER11	ER11A-BS	0.95
	-ER11-100	11	19	100	165.4	ER11	ER11A-BS	1.00
	-ER16-70	16	28	70	135.4	ER16	ER16A-BS	1.20
	-ER16-100	16	28	100	165.4	ER16	ER16A-BS	1.30
	-ER16-150	16	28	150	215.4	ER16	ER16A-BS	1.40
	-ER20-70	20	34	70	135.4	ER20	ER20A-BS	1.40
	-ER20-100	20	34	100	165.4	ER20	ER20A-BS	1.50
	-ER20-150	20	34	150	215.4	ER20	ER20A-BS	1.80
	-ER25-70	25	42	70	135.4	ER25	ER25UM-BS	1.30
	-ER25-100	25	42	100	200.4	ER25	ER25UM-BS	1.65
	-ER25-150	25	42	150	215.4	ER25	ER25UM-BS	2.25
	-ER32-70	32	50	70	135.4	ER32	ER32UM-BS	1.30
	-ER32-100	32	50	100	165.4	ER32	ER32UM-BS	1.70
	-ER32-150	32	50	150	215.4	ER32	ER32UM-BS	2.50
	-ER40-80	40	63	80	145.4	ER40	ER40UM-BS	1.50
	-ER40-100	40	63	100	165.4	ER40	ER40UM-BS	2.05
	-ER40-150	40	63	150	215.4	ER40	ER40UM-BS	3.10
-ER50-85	50	78	85	145.4	ER50	ER50UM-BS	1.70	
-ER50-100	50	78	100	165.4	ER50	ER50UM-BS	2.10	

⚠ 请不要使用杆部有缺口或有平面的刀具禁止空锁（未插入刀具锁紧）

⚠ Please do not use the bar there are gaps in the Department of the cutting tool or a flat. Ban air lock (not insert a cutting tool by tight).



BT-ER 弹性刀柄 BT-ER Collet chuck

型号说明 Model explanation

BT50 ER 20 100

刀柄形状 夹头略号 从基准面开始的长度 最大把握直径



材质为特殊合金钢
硬度为55 ± 1HRC

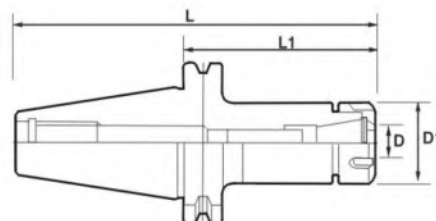

- 设计简单方便，精度高。
- Designs simply convenient, the precision is high.

型号 Cat.No	尺寸Size				筒夹 suitable collet	扳手 suitable spanner	重量 Weight (KG)
	D	D1	L1	L			
BT50 -ER16-100	16	28	100	201.8	ER16	ER16A-BS	4.30
-ER16-150	16	28	150	251.8	ER16	ER16A-BS	4.40
-ER20-100	20	34	100	201.8	ER20	ER20A-BS	4.30
-ER20-150	20	34	150	251.8	ER20	ER20A-BS	4.70
-ER20-200	20	34	200	301.8	ER20	ER20A-BS	4.90
-ER25-90	25	42	90	201.8	ER25	ER25UM-BS	4.40
-ER25-150	25	42	150	251.8	ER25	ER25UM-BS	4.70
-ER25-200	25	42	200	301.8	ER25	ER25UM-BS	5.50
-ER32-100	32	50	100	201.8	ER32	ER32UM-BS	4.80
-ER32-150	32	50	150	251.8	ER32	ER32UM-BS	5.30
-ER32-200	32	50	200	301.8	ER32	ER32UM-BS	5.50
-ER40-100	40	63	100	201.8	ER40	ER40UM-BS	4.40
-ER40-150	40	63	150	251.8	ER40	ER40UM-BS	5.20
-ER40-200	40	63	200	301.8	ER40	ER40UM-BS	6.20
-ER50-90	50	78	90	291.8	ER50	ER50UM-BS	4.60
-ER50-120	50	78	120	221.8	ER50	ER50UM-BS	5.50
-ER50-165	50	78	165	266.8	ER50	ER50UM-BS	6.10

- 1.筒夹样式有弹性、止水、刚性攻牙、伸缩攻牙、极小内孔等共选择。
- 2.弹性筒夹偏摆精度有标准级（0.015MM以内），A级（0.01以内）。
- 3.整支通孔，利于出水及抗震。
- 4.装夹时筒夹必须先置入螺帽，再装入刀具，最后锁入刀具。
- 5.刀具置入筒夹，必须超出筒夹内控有效夹持长度，避免不当锁紧，造成损失。
- 6.使用正确扳手装置，不可任意改变以免造成损坏。

- 1.Collet style aflexibe,sealing,rigid tapping,stretching tapping,a very small hole,etc.were selected.
- 2.Collet Runout accuracy of standard-class (0.015MM or less) , A level (0.01 or less) .
- 3.Whole branch hole,which will help the water and shock.
- 4.Collet fixture must be placed when the nut,and then loaded knives, finally locked into the shank.
- 5.Kinives into Collet Collet bore must go beyond the effective clamping length,avoid losses.
- 6.To use the correct wrench device, can not be arbitrarily changed so as to avoid damage.



BT-C 强力型刀柄
BT-C Milling chuck



材质为特殊合金钢
硬度为55±1HRC

型号说明 Model explanation

BT40	C	32	105
------	---	----	-----

刀柄形状 从基准面开始的长度
夹头略号 最大把握直径

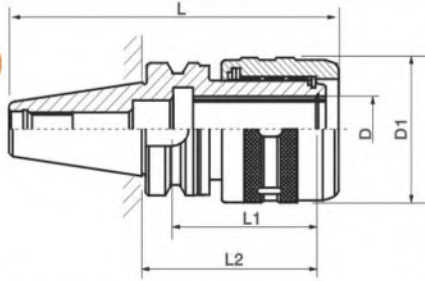

● 设计简单方便，精度高。
● Designs simply convenient, the precision is high.

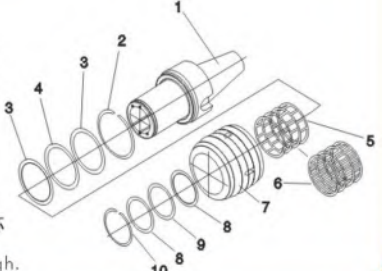

- 1、本体
- 2、同心扣环
- 3、垫片
- 4、平面油封
- 5、轴承钢
- 6、滚钉
- 7、螺帽
- 8、垫片
- 9、平面油封
- 10、同心扣环

型号 Cat.No	尺寸Size					筒夹 suitable collet	扳手 suitable spanner	重量 Weight (KG)	
	D	L2	L1	L	D1				
BT30	-C20-80	20	80	45	70	128.4	53	C20-BS C20	1.80
	-C25-80	25	80	48	73	128.4	60	C25-BS C25	1.95
BT40	-C20-105	20	105	45	70	170.4	53	C20-BS C20	2.60
	-C25-105	25	105	48	73	170.4	60	C25-BS C25	2.65
	-C32-105	32	105	50	76	170.4	70	C32-BS C32	2.80
	-C32-135	32	135	50	76	200.4	70	C32-BS C32	3.00
	-C32-165	32	165	50	76	230.4	70	C32-BS C32	3.50
BT50	-C20-105	20	105	45	70	206.8	53	C20-BS C20	4.50
	-C25-105	25	105	48	73	206.8	60	C25-BS C25	4.60
	-C32-105	32	105	60	95	206.8	70	C32-BS C32	5.15
	-C32-135	32	135	60	95	236.8	70	C32-BS C32	5.90
	-C32-165	32	165	60	95	266.8	70	C32-BS C32	6.60
	-C42-115	42	115	60	98	216.8	92	C42-BS C42	6.10
	-C42-135	42	135	60	98	236.8	92	C42-BS C42	6.60
-C42-165	42	165	60	98	266.8	92	C42-BS C42	7.40	

支持高精度的加厚设计及独特的夹缝结构
Support for high-precision thick design and a unique structure of the slit

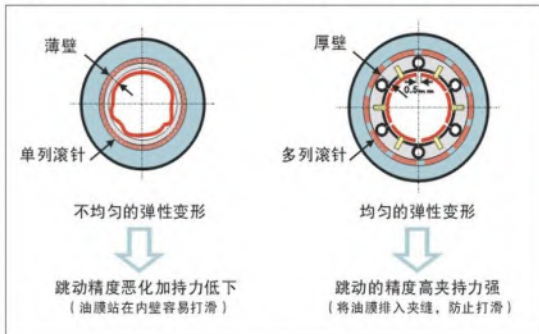

夹头的加厚设计，可以增加刚性，以承受立铣刀的重切削。而采用独特的夹缝结构，可以使夹持部分均匀变形，以获得强大的夹持力及稳定的跳动精度。

Chuck's thicker design can increase the rigidity to withstand the heavy cutting end mills. The use of a unique slit structure, and can make gripping part of the uniform deformation in order to obtain a powerful clamping force and stability of the beating of accuracy.

- 1.刀柄内孔分割6槽以防止滑动，并加大夹持力。
- 2.采用两线装置为使当滑动至针锥面时滚动摩擦及脱落减至最小。
- 3.刀具置入筒夹需超出筒夹有效夹持长度，以避免因非完全夹持，导致筒夹损坏、变形或脱刀情形发生。

1. Shank hole split six slots in order to prevent sliding, and increase the clamping force.
2. Two-wire device to make when sliding to rolling friction when the needle cone and minimize shedding.
3. The tool onto Collet Collet need to exceed the effective clamping length, in order to avoid non-totally gripping, resulting in Collet damaged, deformed or de-cutter things from happening.

- 夹持部加厚设计，提高刚性，防止震动。
- 夹持力强，跳动精度高。

- Department of thicker clamping design, improve the rigidity and prevent vibration.
- Clamping strong, beating high precision.



BT-C强力型刀柄套装
BT-C Milling chuck set



型号 Cat.No	COLLET	内附筒夹规格 Specifications included Collet
BT30-C20-80-7PCS	C20	3,4,6,8,10,12,16
BT40-C20-105-7PCS	C20	3,4,6,8,10,12,16
BT40-C32-105-7PCS	C32	6,8,10,12,16,20,25
BT40-C32-105-7PCS	C32	1/4,5/16,3/8,1/2,3/4,5/8,1"
BT50-C20-105-7PCS	C20	3,4,6,8,10,12,16
BT50-C32-105-7PCS	C32	6,8,10,12,16,20,25
BT50-C32-105-7PCS	C32	3/4,3/8,5/8,5/16, 1/4,1/2,1"
BT50-C42-115-8PCS	C42	6,8,10,12,16,20,25,32
BT50-C42-115-8PCS	C42	1/4,5/16,3/8,1/2,3/4,5/8,1" , 1-1/4

- 以上套装含刀柄1支、筒夹7个或8个、木盒1个、扳手1支、拉钉1支。
- Set containing more than one knife handle, Collet 7 or 8, a wooden box, a wrench, pull a nail.



BT-FMA平面铣刀柄 (英制)
BT-FMA Face mill holder



材质为特殊合金钢
硬度为55±1HRC



型号说明 Model explanation

BT40	FMA	25.4	60
------	-----	------	----

刀柄形状 从基准面开始的长度
夹头略号 最大把握直径

- 专用面铣刀盘用刀柄
- The special-purpose face milling cutter plate uses the hilt.

型号 Cat.No	尺寸 Size							重量 Weight (KG)
	D1	D	L1	L2	L	K1	K2	
BT30 -FMA25.4-45	25.4	50	45	20	113.4	4.52	9.52	1.00
-FMA25.4-60	25.4	50	60	20	128.4	4.52	9.52	1.30
-FMA31.75-45	31.75	60	45	22	115.4	6.7	12.7	1.35
BT40 -FMA25.4-45	25.4	50	45	20	130.4	4.52	9.52	1.80
-FMA25.4-90	25.4	50	90	20	175.4	4.52	9.52	2.60
-FMA31.75-45	31.75	60	45	22	132.4	6.7	12.7	2.00
-FMA31.75-90	31.75	60	90	22	177.4	6.7	12.7	2.90
-FMA38.1-60	38.1	75	60	25	150.4	8.87	15.87	2.80
-FMA50.8-90	50.8	98	90	26	181.4	9.75	19.05	4.60
BT50 -FMA25.4-45	25.4	50	45	20	166.8	4.52	9.52	4.40
-FMA25.4-90	25.4	50	90	20	211.8	4.52	9.52	5.10
-FMA25.4-150	25.4	50	150	20	271.8	4.52	9.52	6.10
-FMA31.75-45	31.75	80	45	22	168.8	6.7	12.7	4.50
-FMA31.75-90	31.75	80	90	22	213.8	6.7	12.7	5.70
-FMA31.75-150	31.75	80	150	22	273.8	6.7	12.7	6.00
-FMA38.1-60	38.1	60	60	25	186.8	8.87	15.87	4.90
-FMA38.1-150	38.1	98	150	25	276.8	8.87	15.87	5.70
-FMA50.8-90	50.8	95	90	26	217.8	9.75	19.05	6.95
-FMA50.8-150	50.8	95	150	26	277.8	9.75	19.05	7.90
-FMA47.62-75	47.62	128.75	75	32	208.8	12.5	25.4	7.90

- 整支通孔，利于出水及抗震。
- The entire branch hole, which will help the water and shock.
- 附带紧固螺丝。
- With fastening screws.
- 试用中心内冷时，请另外订购带有孔的紧固螺丝。
- Use cold center, please also ordered with fastening screw holes.



FMA-FMB 面铣刀转换接头
FMA-FMB face mill transition joint

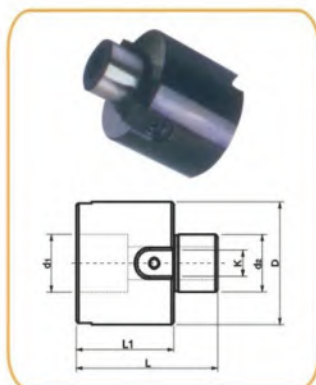

型号 Cat.No	尺寸 Size					
	d2	d1	D	L1	L	K
FMA25.4-FMB22	22	25.4	47	42	62	10
FMA25.4-FMB27	27	25.4	60	42	62	12.4
FMA31.75-FMB32	32	31.75	76	42	66	14
FMA25.4×42	25.4	25.4	47	42	62	9.52
FMB22-FMA25.4	25.4	22	47	42	60	9.52
FMB27-FMA25.4	25.4	27	60	42	62	9.52
FMB32-FMA31.75	31.75	32	76	42	66	12.7
FMB22×42	22	22	47	42	60	10
FMB27×42	27	27	60	42	62	12



BT-FMB 平面铣刀柄 (公制)
BT-FMB Face mill holder



材质为精锻合金钢
硬度为55±1HRC

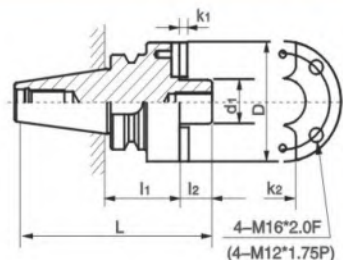

型号说明 Model explanation

BT40 FMB 22 60

刀柄形状

夹头略号

从基准面开始的长度

最大把握直径

● 专用面铣刀盘用刀柄

● The special-purpose face milling cutter plate uses the hilt.

型号 Cat.No	尺寸 Size							重量 Weight (KG)		
	d1	D	L1	L2	L	K1	K2			
BT30	-FMB22-45	22	48	45	18	111.4	4.8	10	0.85	
	-FMB27-45	27	60	45	20	113.4	5.8	12	1.20	
	-FMB32-45	32	78	45	22	115.4	6.8	14	1.35	
BT40	-FMB22-45	22	48	45	18	128.4	4.8	10	1.45	
	-FMB22-60	22	48	60	18	143.4	4.8	10	1.70	
	-FMB22-100	22	48	100	18	183.4	4.8	10	2.10	
	-FMB22-120	22	48	120	18	205.4	4.8	10	2.30	
	-FMB22-150	22	48	150	18	233.4	4.8	10	3.10	
	-FMB22-200	22	48	200	18	283.4	4.8	10	3.80	
	-FMB22-250	22	48	250	18	283.4	4.8	10	4.50	
	-FMB22-300	22	48	300	18	333.4	4.8	10	5.10	
	-FMB27-45	27	68	45	20	128.4	5.8	12	1.60	
	-FMB32-45	32	78	45	22	128.4	6.8	14	1.70	
	-FMB40-45	40	80	45	25	128.4	8.3	16	2.10	
	BT50	-FMB22-45	22	48	45	18	164.8	4.8	10	4.50
		-FMB22-100	22	48	100	18	201.8	4.8	10	5.20
-FMB22-150		22	48	150	18	269.8	4.8	10	6.80	
-FMB22-200		22	48	200	18	319.8	4.8	10	7.00	
-FMB22-250		22	48	250	18	369.8	4.8	10	8.00	
-FMB27-75		27	60	75	20	176.8	5.8	12	5.20	
-FMB27-150		27	60	150	20	269.8	5.8	12	7.50	
-FMB27-200		27	60	200	20	319.8	5.8	12	9.50	
-FMB32-75		32	78	75	22	176.8	6.8	14	5.50	
-FMB32-150		32	78	150	22	269.8	6.8	14	7.00	
-FMB40-75		40	89	75	25	176.8	8.3	16	5.90	
-FMB40-150		40	89	150	25	269.8	8.3	16	7.80	
-FMB60-60		60	140	60	26	161.8	12.5	25.4	8.50	

● 整支通孔, 利于出水及抗震。

● 附带紧固螺丝。

● 试用中心内冷时, 请另外订购带有孔的紧固螺丝。

● The entire branch hole, which will help the water and shock.

● With fastening screws.

● Use cold center, please also ordered with fastening screw holes.



BT-SLA 侧固式铣刀柄
BT-SLA Side lock end mill holder



材质为特种合金钢
硬度为HRC55±1

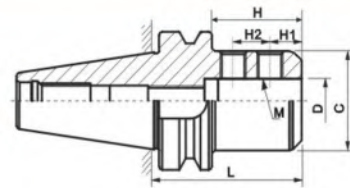

型号说明 Model explanation

BT40 SLA 10 60

刀柄形状

夹头略号

从基准面开始的长度

最大把握直径

- 不分孔径皆为二底锁紧螺丝
- 用于夹持具有侧固平面的刀具
- Regardless of aperture jie Wei 2 locking screws.
- For gripping the tool with a side of solid plane.

型号 Cat.No	尺寸 Size						重量 Weight (KG)			
	φD	L	φC	H		H1		H2	M	
				MIN	MAX					
BT30	-SLA6-60	6	60	25	20	35	18	--	M6	0.55
	-SLA8-60	8	60	28	20	35	18	--	M8	0.6
	-SLA10-60	10	60	35	35	50	14	13	M10	0.7
	-SLA12-60	12	60	40	35	50	14	13	M10	0.75
	-SLA16-90	16	90	40	55	70	25	20	M10	1.05
	-SLA20-90	20	90	50	55	70	25	20	M12	1.1
	-SLA25-90	25	90	50	55	70	25	20	M12	1.7
	-SLA32-105	32	105	60	65	80	25	25	M16	1.85
BT40	-SLA6-75	6	75	25	20	35	18	--	M6	1.2
	-SLA8-75	8	75	28	20	35	18	--	M8	1.25
	-SLA10-75	10	75	35	35	50	14	13	M10	1.3
	-SLA12-75	12	75	40	35	50	14	13	M10	1.35
	-SLA16-90	16	90	40	55	70	25	20	M10	1.6
	-SLA20-90	20	90	50	55	70	25	20	M12	1.65
	-SLA25-90	25	90	50	55	70	25	20	M12	2.5
	-SLA32-105	32	105	60	65	80	25	25	M16	2.8
	-SLA40-105	40	105	70	65	80	25	25	M20	2.95
	-SLA42-105	42	105	70	65	80	25	25	M20	3.15
BT50	-SLA6-105	6	105	25	20	35	--	--	M6	3.9
	-SLA8-105	8	105	28	20	35	--	--	M8	3.9
	-SLA10-105	10	105	35	35	50	13	13	M10	4.0
	-SLA12-105	12	105	40	35	50	13	13	M10	4.0
	-SLA16-105	16	105	50	55	70	20	20	M10	4.5
	-SLA20-105	20	105	50	55	70	20	20	M12	4.7
	-SLA20-150	20	150	50	55	70	20	20	M12	5.5
	-SLA20-200	20	200	50	55	70	20	20	M12	6.0
	-SLA25-105	25	105	50	55	70	20	20	M12	5.2
	-SLA25-150	25	150	50	55	70	20	20	M12	6.0
	-SLA25-200	25	22	50	55	70	20	20	M12	7.5
	-SLA32-105	32	105	60	65	80	25	25	M16	6.0
	-SLA32-150	32	150	60	65	80	25	25	M16	6.5
	-SLA32-200	32	200	60	65	80	25	25	M16	7.3
	-SLA40-105	40	105	70	65	80	25	25	M20	6.6
	-SLA42-105	42	105	70	65	80	25	25	M20	7.2
	-SLA42-150	42	150	70	65	80	25	25	M20	7.8
-SLA42-250	42	250	70	65	80	25	25	M20	7.8	
-SLA50.8-120	51	120	90	65	80	35	35	M20	7.4	

- 刀具装着时，刃物的槽口平面部时与刀柄的侧固螺钉对齐，强力锁紧。
侧固式柄部形状有不同，使用的侧固式刀柄也有区别，必须确认侧固式螺钉的位置。
- When the cutting tool is installing, when edge's notch even face alines with the hilt side solid bolt, force locking.
The side solid-like handle department shape has the difference, the use side solid-like hilt also has the difference, must confirm the side solid-like bolt's position.



BT-MTA 莫式锥度刀柄
BT-MTA Morse taper sleeve (sleeve (typeA))

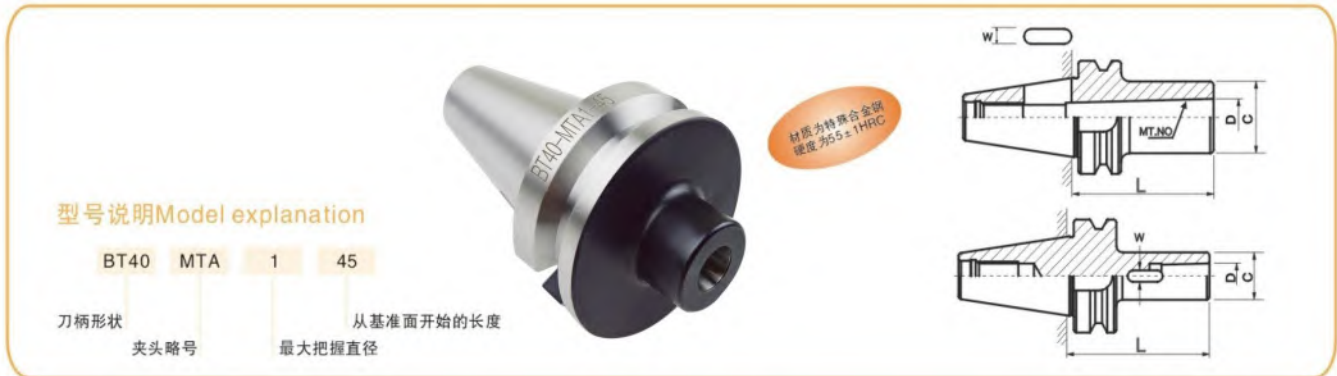

型号 Cat.No	尺寸 Size					重量 Weight (KG)	
	MT.NO	D	L	W	C		
BT30	MTA1-45	MTA1	12.065	45	20	5.6	0.55
	MTA2-45	MTA2	17.780	45	30	6.6	0.6
	MTA3-45	MTA3	23.825	45	40	8.4	0.7
BT40	MTA1-45	MTA1	12.065	45	25	5.6	1.05
	MTA1-120	MTA1	12.065	120	25	5.6	1.4
	MTA2-45	MTA2	17.780	45	32	6.6	1.1
	MTA2-120	MTA2	17.780	120	32	6.6	1.85
	MTA3-75	MTA3	23.825	75	40	8.4	1.25
	MTA3-135	MTA3	23.825	135	40	8.4	1.9
	MTA4-90	MTA4	31.065	90	50	12.4	1.45
MTA4-165	MTA4	31.065	165	50	12.4	2.5	
BT50	MTA1-45	MTA1	12.065	45	25	5.6	3.8
	MTA1-120	MTA1	12.065	120	25	5.6	4.3
	MTA1-180	MTA1	12.065	180	25	5.6	5.0
	MTA2-45	MTA2	17.780	45	25	6.6	4.0
	MTA2-135	MTA2	17.780	135	25	6.6	4.7
	MTA2-180	MTA2	17.780	180	25	6.6	5.0
	MTA3-75	MTA3	23.835	75	40	8.4	3.8
	MTA3-150	MTA3	23.835	150	40	8.4	5.0
	MTA3-180	MTA3	23.835	180	40	8.4	5.5
	MTA4-90	MTA4	31.267	90	50	12.4	4.5
	MTA4-180	MTA4	31.267	180	50	12.4	5.5
	MTA5-105	MTA5	44.399	105			4.3

- 装刀具时，扁尾方向与刀柄孔对准插入，刀具向上用铜锤子，重重敲击拉钉部分几下即可。
- 卸刀具时，对准扁孔的记号，用锤子敲击，卸刀具。这时请注意不要让刀具飞出来。

- When installs the cutting tool, the flat tail direction and the hilt hole alignment insertion, the cutting tool with the copper clock, layer on layer raps puller bolt part several upwardly then.
- When unloads the cutting tool, aims at the flat hole the symbol, with the clock sub-rap, unloads the cutting tool. By now please note do not let the cutting tool fly.



BT-MTB 莫式锥度刀柄
BT-MTB Morse taper sleeve (sleeve typeB)



型号说明 Model explanation

BT40 MTB 1 45
 刀柄形状 夹头略号 从基准面开始的长度 最大把握直径

- 采用长拉钉形式
Pull nails with long-form
- 报价时不含长拉钉, 需单独订购
Quote a long time without pulling nails, need to be ordered separately.

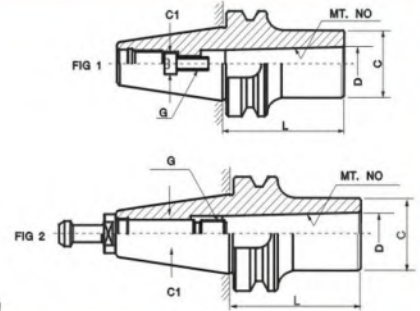

型号 Cat.No	样式 Manner	尺寸 Size					重量 Weight (KG)	
		D	L	C	C1	G		
BT30	MTB1-45	1	12.065	45	25	10	M6×1	0.55
	MTB2-45	2	12.065	45	32	10	M10×1.5	0.55
BT40	MTB1-45	1	12.065	45	25	10	M6×1	1.05
	MTB2-45	2	17.780	45	32	13.5	M10×1.5	1.85
	MTB3-75	2	23.825	75	42	18	M12×1.75	1.3
	MTB4-75	2	31.267	75	50	20.5	M16×2	1.4
BT50	MTB1-45	1	12.065	45	25	10	M6×1	3.8
	MTB2-45	2	17.780	45	32	16	M10×1.5	3.9
	MTB3-60	2	23.825	60	42	18	M12×1.75	4.0
	MTB4-75	2	31.267	75	50	20.5	M16×2	4.2
	MTB5-120	1	44.399	120	70	22.5	M20×2.5	4.3

- 刀具装着时, 请锁紧刀柄上装刀用的锁紧螺钉。
- 拆卸刀具时, 先放松拉紧螺钉2-3圈, 然后在刀柄的头部分用锤子敲击, 放松接触面后, 再扭松螺钉, 取出刀具。
- When the cutting tool is installing, please lock the gib screw which the hilt upper garment knife uses.
- When disassembles the cutting tool, relaxes the tautness bolt first 2-3, then in the hilt head part with the clock sub-rap, after relaxing the contact face, then turns the loose bolt, takes out the cutting tool.

	型号 Cat.No	配套刀柄 Supporting Shank	G
	MTB长拉钉	BT30-45° -MTB2	BT30-MTB2
BT40-45° -MTB2		BT40-MTB2	M10×1.5
BT40-45° -MTB3		BT40-MTB3	M12×1.75
BT40-45° -MTB4		BT40-MTB4	M16×2
BT50-45° MTB2		BT50-MTB2	M10×1.5
BT50-45° -MTB3		BT50-MTB3	M12×1.75
BT50-45° -MTB4		BT50-MTB4	M16×2



BT-APU-体式钻夹头 BT-APU Ddrill chuck



型号说明 Model explanation

BT40 APU 13 100

刀柄形状

夹头略号

从基准面开始的长度
最大把握直径

- 请把刀具柄部插到夹头后,使柄部分插入夹头。
- 锁紧刀具时请将刀具的柄径部分全部插入。
- 特别是小径的情况下,请确认跳动精度。
- 刀具夹紧时,刀具先插夹头,用手扭紧,最后用专用扳手强力锁紧。
- Please inserts the cutting tool handle department after the cartridge,do cause the handle part insertion cartridge.Locks when the cutting tool please completely insert cutting tool's handle diameter part.
- When the cutting tool clamps,the cutting tool inserts the cartridge first,turns tight with the hand,finally uses the special spanner force to lock.

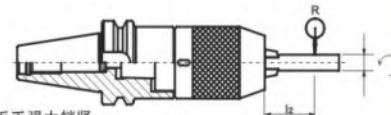
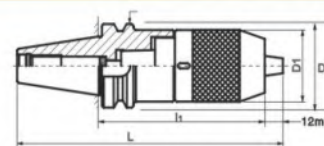

型号 Cat.No	尺寸 Size				把握直径 Chuck Dia	重量 Weight (KG)
	D1	D2	L1	L		
BT30 -APU8-80	36.5	46	80	137.4	0.3~8	0.80
-APU13-110	48	46	110	158.4	1~13	1.85
-APU16-110	55.5	46	110	158.4	3~16	2.18
BT40 -APU8-85	36.5	0.63	85	150.4	0.3~8	1.46
-APU13-105	48	0.63	105	170.4	1~13	2.00
-APU13-130	48	0.63	130	195.4	1~13	2.33
-APU16-105	55.5	0.63	105	170.4	3~16	2.33
-APU16-130	55.5	0.63	130	195.4	3~16	2.60
BT50 -APU8-90	36.5	100	90	191.8	0.3~8	4.20
-APU13-110	48	100	110	211.8	1~13	4.70
-APU13-180	48	100	180	281.8	1~13	5.80
-APU16-115	55.5	100	115	216.8	3~16	5.10
-APU16-130	55.5	100	130	236.8	3~16	4.80
-APU16-190	55.5	100	190	296.8	3~16	6.10

- 订购刀柄附带钻夹头专用扳手一支。
- The order hilt drills cartridge special spanner one in passing.



C-APU 直柄式钻夹头 C-APU Integrated keyless drill chuck



MT-APU莫式柄一体式钻夹头 MT-APU Mo's drill chuck



型号 Cat.No	L
C20-APU8	120
-APU13	140
-APU16	150
C25-APU13	161
-APU16	165
C32-APU13	165
-APU16	165

型号 Cat.No	L
MT2-APU8	164
MT3-APU13	179
-APU16	184
MT4-APU13	202
-APU16	207



BT-HM 液压刀柄
BT-HM Hydraulic expansion chuck



型号说明 Model explanation

BT40 HM 10 90
 刀柄形状 夹头略号 从基准面开始的长度 最大把握直径

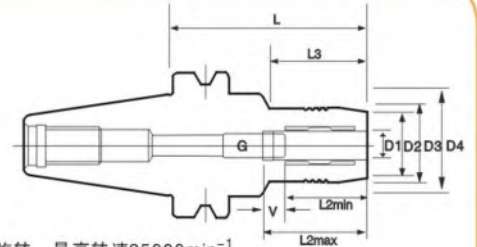

- 动平衡好、精度高, 适合高速旋转, 最高转速25000min⁻¹
- 适合精度加工使用。
- The transient equilibrium is good, the precision is high, suits the high speed revolving highest rotational speed 25000min⁻¹
- Suits the precision sizing use.

型号 Cat.No	尺寸 Size									筒夹 suitable Collet	G
	D1	D2	D3	D4	L	L2max	L2min	V	L3		
BT30 -HM6-70	6	26	29	44	70	37.5	27.5	10	23	--	M5
-HM8-70	8	27	30	44	70	37.5	27.5	10	23	--	M6
-HM10-75	10	29	32	44	75	42.5	32.5	10	42	--	M8×1
-HM12-75,85	12	31	34	44	75,85	47.5	37.5	10	31.5	HM12	M10×1
-HM14-85	14	33	36	44	85	47.5	37.5	10	44	--	M10×1
-HM16-90	16	36	40	44	90	52.5	42.5	10	46	--	M10×1
-HM18-90	18	38	42	44	90	52.5	42.5	10	46	--	M10×1
-HM20-90	20	40	44	44	90	52.5	42.5	10	46	HM20	M10×1
BT40 -HM6-65,90,140	6	26	29	49.5	65,90,140	37.5	27.5	10	23,38,38	--	M5
-HM8-65,90,140	8	27	30	49.5	65,90,140	37.5	27.5	10	23,40,40	--	M6
-HM10-65,90,140	10	29	32	49.5	65,90,140	42.5	32.5	10	23,42,42	--	M8×1
-HM12-65,90,140	12	31	34	49.5	65,90,140	47.5	37.5	10	23,44,44	--	M8×1
-HM14-65,95,135	14	33	36	49.5	65,95,135	47.5	37.5	10	23,44,44	HM12	M10×1
-HM16-65,90,140	16	36	40	49.5	65,90,140	52.5	42.5	10	23,46,46	--	M10×1
-HM18-65,95,135	18	38	42	49.5	65,95,135	52.5	42.5	10	23,46,46	--	M10×1
-HM20-65,90,140	20	40	44	49.5	65,90,140	52.5	42.5	10	23,31.5,48	HM20	M10×1
-HM25-100,135	25	55	60	49.5	100,135	61.0	51	10	73	--	M16×1
-HM32-105,135	32	58	63	49.5	105,135	61.0	65	10	78	HM32	M16×1
BT50 -HM6-90,120,140	6	26	29	49.5	90,120,140	37.5	27.5	10	30,38,38	--	M5
-HM8-90,120,140	8	27	30	49.5	90,120,140	37.5	27.5	10	30,40,40	--	M6
-HM10-90,120,140	10	29	32	49.5	90,120,140	42.5	32.5	10	40,42,42	--	M8×1
-HM12-90,120,140	12	31	34	49.5	90,120,140	47.5	37.5	10	30,44,44	HM12	M8×1
-HM14-90,120,140	14	33	36	63	90,120,140	47.5	37.5	10	30,44,44	--	M10×1
-HM16-90,120,140	16	36	40	63	90,120,140	52.5	42.5	10	30,46,46	--	M10×1
-HM18-90,120,140	18	38	42	63	90,120,140	52.5	42.5	10	30,46,46	--	M10×1
-HM20-90,120,140	20	40	44	-	90,120,140	52.5	42.5	10	30,48,48	HM20	M10×1
-HM25-105,150	25	55	60	-	105,150	61.0	51	10	67	--	M16×1
-HM32-115,150	32	58	63	-	115,150	65.0	55	10	77,112	HM32	M16×1

- 订购刀柄配送扳手一支。
- 不附带筒夹, 请使用液压专用筒夹。
- 不附带拉钉。
- 夹具切削工具时, φ6-φ32切削工具柄部要使用能插入工具公差h6以内的切削工具。
- Order hilt allocation spanner.
- Does not supplement the collet, the collet invites the hydraulic pressure knife special-purpose collet.
- Does not supplement the puller bolt to select.
- When jig cutting tool, φ6-φ32the cutting tool handle department must use can insert in tool common



BT-MX 后拉式刀柄
BT-MX Collet chuck



型号说明 Model explanation

BT40 MX 12 90

刀柄形状

夹头略号

从基准面开始的长度
最大把握直径

- 预设动平衡G2.5,30000min⁻¹
- 侧面锁紧,方便更实用,振动精度0.003MM

- Preinstall transient equilibri G2.5,30000min⁻¹
- The side locking, facilitates is more practical, vibration precision 0.003MM

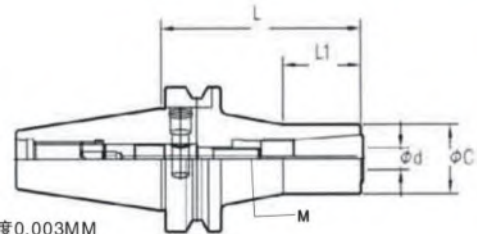

型号 Cat.No	尺寸 Size					重量 Weight (KG)	
	D	L	C	L1	M		
BT30	-MX8-90	3.0-10.0	90	22	36	M8	0.6
	-MX12-105	3.0-12.0	105	30	35	M12	0.7
BT40	-MX8-85	3.0-10.0	85	22	36	M8	1.2
	-MX8-105	3.0-10.0	105	22	40	M8	1.5
	-MX8-120	3.0-10.0	120	22	43	M8	1.9
	-MX12-90	3.0-12.0	90	30	35	M12	1.2
	-MX12-105	3.0-12.0	105	30	40	M12	1.6
	-MX12-120	3.0-12.0	120	30	43	M12	1.9
	BT50	-MX8-105	3.0-10.0	105	22	40	M8
-MX8-135		3.0-10.0	135	22	43	M8	4.4
-MX8-165		3.0-10.0	165	22	35	M8	4.8
-MX12-105		3.0-12.0	105	30	40	M12	4.5
-MX12-135		3.0-12.0	135	30	40	M12	4.8
-MX12-165		3.0-12.0	165	30	40	M12	5.1

- 全系列可选购中心通油型。
- 迷你小径刀柄扳手, 不带套筒, 带筒请另订购。

- The entire series may select and purchase the center to pass the oil type.
- The miniature trail hilt belt spanner, does not bring the sleeve, the sleeve pleas to order separately buys.

MS 筒夹
MS collet

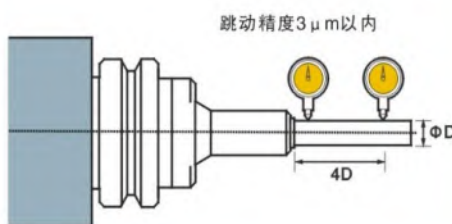

型号 Cat.No		标准 STANDARD	精密 PCLASS
MX8-3	MX12-4	0.005	0.003
-4	-5		
-5	-6		
-6	-8		
-8	-10		
-10	-12		



ISO-GER 高速ER刀柄
ISO-GER High speed er collet chuck

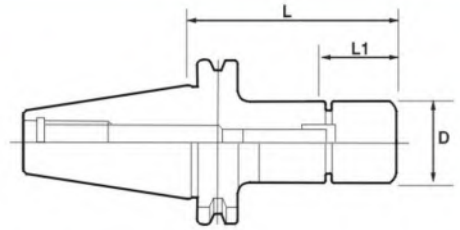

型号说明 Model explanation

ISO25 GER 20 45

刀柄形状

夹头略号

从基准面开始的长度
最大把握直径

● 预设动平衡, 最高可连40000min⁻¹

● Preinstall transient equilibri, high40000min⁻¹

型号 Cat.No		尺寸 Size			螺母 Nut	筒夹 suitable Collet	扳手 suitable spanner	把握直径 Chuching Dia
		D	L1	L				
ISO20	ISO20-GER16-45	30	25	45	GER16	ER16	GER16	1~10
ISO25	ISO25-GER20-45	35	27	45	GER20	ER20	GER20	1~13
ISO30	ISO30-GER16-60	30	25	60	GER16	ER16	GER16	1~10
	-GER25-60	40	30	60	GER25	ER25	GET25	1~16



ISO-GSK 弹性刀柄
ISO-GSK Flexible Shank

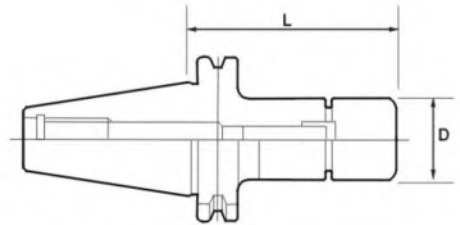

型号说明 Model explanation

ISO25 GSK 10 35

刀柄形状

夹头略号

从基准面开始的长度
最大把握直径

● 预设动平衡, 最高可连40000min⁻¹

● Preinstall transient equilibri, high40000min⁻¹

型号 Cat.No		尺寸 Size		最高旋转数 MAX.min-1	螺母 Nut	筒夹 suitable Collet	扳手 suitable spanner	把握直径 Chuching Dia
		D	L1					
ISO20	ISO20-GSK6-30	19.5	30	40000	GSK6	STK6	GSK6	0.7~6.0
	-GSK10-45	27.5	45	40000	GSK10	STK10	GSK10	1.75~10.0
ISO25	ISO25-GSK10-45	27.5	45	40000	GSK10	STK10	GSK10	1.75~10.0
ISO30	ISO30-GSK10-60	27.5	60	40000	GSK10	STK10	GSK10	1.75~10.0
	-GSK16-60	40	60	30000	GSK16	STK16	GSK16	2.75~16.0



无键槽锁刀座
Locks the tool apron without the key slot



型号 Cat.No
BT30
ISO20
ISO25
ISO30