

微调镗孔刀柄 MICRO BORING BAR

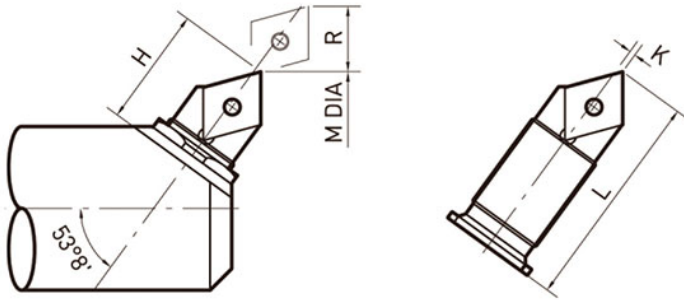

微调镗孔刀杆 MICRO BORING UNIT

TR.M



TOP ADJUST 方式

- 前方已调整好尺寸，解决了微调时通过扭紧或扭开 Retaining Bolt 的繁琐环节。
- Adjusting boring dimension(range) on the front side.

尺数调整方法

- 松开 Retaining Bolt，将 Tool Body 调到 Adjusting dial 要设定的范围内为止。
- Retaining Bolt 完全锁紧后再松开 1/2 圈。
- 扭转前方的 Adjusting dial 微调完成。

Adjusting method of boring dimension(range)

- Loosen the Retaining Bolt and turn the Adjusting Dial and then closing the tool body to required boring range.
- Fully close the Retaining Bolt and loosen this bolt by 1/2 turn. Turn the Adjusting Dial on front side.

80° 金刚石刀片 (倾斜贴附型)

ORDER NO.	M Min. Bore	R	H	K	L	INSERT 刀片	SCREW	WRENCH
G2B-2CC	18.3	2.0	8.7	0.4	16.2	CCGT 040102	S1845L6	WR-2 T6

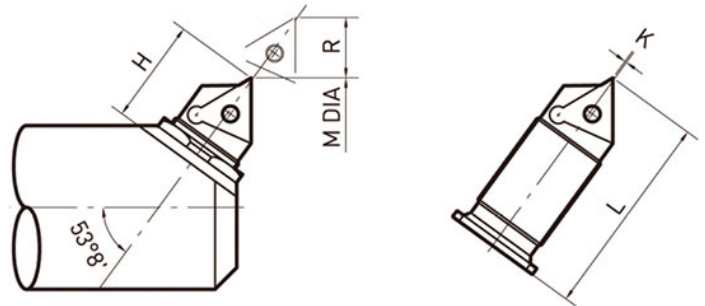

三角形刀片 (倾斜贴附型)

ORDER NO.	M Min. Bore	R	H	K	L	INSERT 刀片	SCREW	WRENCH
G3A -2TC	26.2	5.1	13.0	0.2	25.4	TBGT060104	S2045L6	WR-2.5 T6
G3B -2TC	23.0	1.9			21.4			
G5A -2TC	41.3	10.3	15.9	-1.2	39.7	TCMT110204	S2555 L6	WR-4 T8
G5B -2TC	35.7	5.6			33.3			
G7A -2TC	58.7	12.7	25.4	1.6	55.6	TCMT16T304	S4095 L6	WR-6T 15
G10A-2TC	78.6	22.2	31.8	0.8	76.2			WR-8T 15

Brazed Type Unit

- Counter Boring 时 安全性高。
- It has high stability when counter boring.

M TYPE

CODE NO.			M	R	H	K	L		Insert Rad.
UNIT	BRAZED	INSERT	Min. Bore	Total Adj. Range	Min. Height	Tool Pt. Offset	Insert TYPE	Brazed TYPE	Used As Datum
M1B2	F	E	13.5	1.2	6.4	0.4	—	2.0	0.2
M1A2			16.0	3.2			—		

NOTE 注意

· F为铸件用，E为钢件用。F type : For an Iron foundry E type : For Hardened steel

微调镗孔刀杆 MICRO BORING UNIT

RIGIBORE 'R' & 'TR'

'R' for roughing & semi - finishing /

'TR' for fine - finishing

"R" -- 粗&半--完成/

"TR" -- 完好--完成

显示右手组合

左手组合 (LH) 为镜像

Right Hand Units Shown

Left Hand Units(LH) are mirror image

Adjustment = 0.01mm/.0004ins
on radius per division

Fig A1 90°

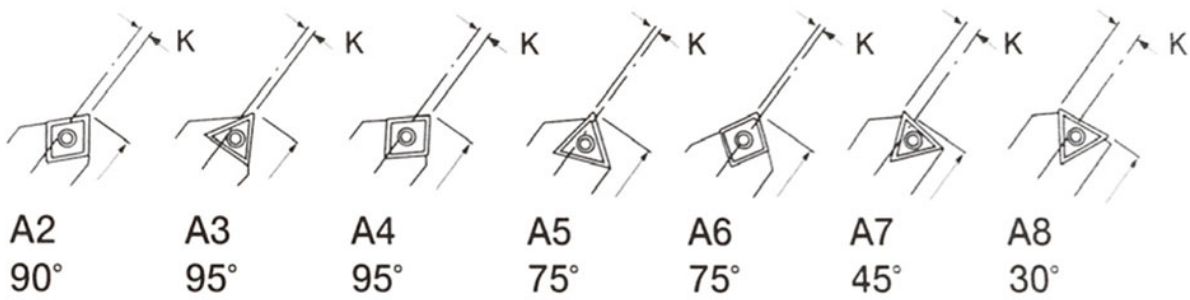
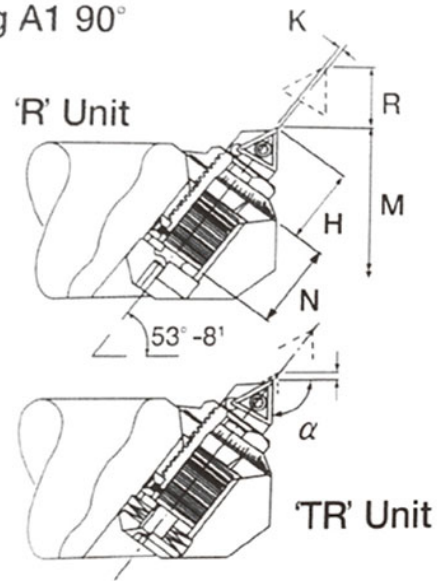

UNIT SIZE	FIG A1 α'	INSERT	CODE	M	R	N	H MIN HEIGHT	K TOOL POINT OFFSET
				MIN BORE POSSIBLE	TOTAL RADIAL ADJUSTMENT			
				MIN-MAX mm	mm	mm	mm	mm
2	A1 90°	TC_06TI(02)	R2A2	20.9 ~ 25.4	4.5	4.5	9.4	1.35
			R2B2	18.2 ~ 20.2	2.0	2.0		
			R2B2S	15.87 ~ 16.62	0.75	0.75		
3		TC_0902(04)	R3A2	28 ~ 35.3	7.3	7.3	13.45	0.8
			R3B2	25 ~ 29	4.0	4.0		
5		TC_1102(04)	TR5A2	41.5 ~ 52.2	10.7	10.7	16.95	2.3
			TR5B2	36.5 ~ 42.1	5.6	5.6		
7		TC_16T3(08)	TR7A2	61.5 ~ 74.3	12.8	12.8	25.55	-0.4
10			TR10A2	81.5 ~ 104.5	23.0	23.0	31.7	

MICRO BORING BAR 微调镗孔刀柄

MAS403 BT-BCA

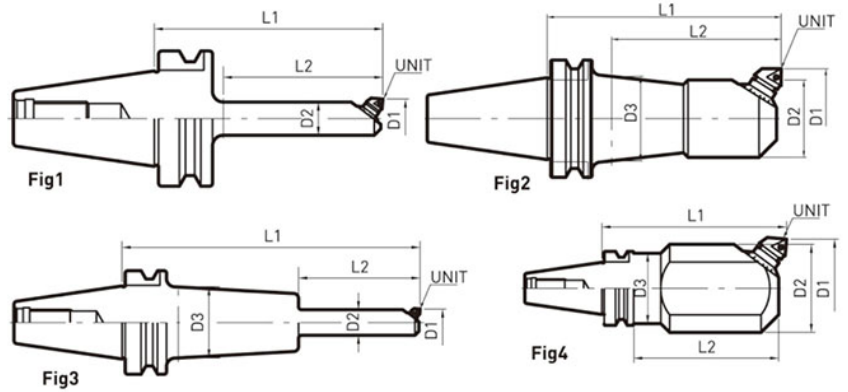

锥体 Taper **AT3** mm

CODE NO.	D		L1	L2	D2	D3	WEIGHT (Kg)	UNIT	INSERT	FIG		
	min.	max.										
BT30	BCA13.5 - 75	13.5	15.9	75	48	13	-	1.2	M1B2F-40	----	3	
	BCA14.5 - 75	14.5	16.9	75	48	14	-	1.2	M1B2E-40	----		
	BCA16.5 - 90	16.5	21.9	90	63	15.5	-	1.3	M1A2F-40	----		
	BCA19 - 90	19	23	90	63	17	17.5	1.3	G2B-2CC	CCGT040102	3	
	BCA23 - 105	23	29	105	78	20	-	1.4	G3B-2TC	TBGT060104	1	
	BCA29 - 120	29	41	120	95	25	28	1.5	G3A-2TC	TBGT060104	3	
	BCA38 - 120	38	49	120	95	36	37	1.7	G5B-2TC	TCMT110204	2	
BT40	BCA46 - 120	46	66	120	98	38	40	1.7	G5A-2TC	TCMT110204	2	
	BCA13.5 - 105	13.5	15.9	105	65	13	-	1.5	M1B2F-40	----	3	
	BCA13.5 - 180	13.5	15.9	180	65	13	44	2.0	M1B2F-40	----		
	BCA14.5 - 105	14.5	16.9	105	65	14	-	1.5	M1B2E-40	----		
	BCA14.5 - 180	14.5	16.9	180	65	14	44	2.0	M1B2E-40	----	3	
	BCA16.5 - 105	16.5	21.9	105	73	15.5	-	1.5	M1A2F-40	----		
	BCA16.5 - 180	16.5	21.9	180	73	15.5	44	2.0	M1A2F-40	----		
	BCA19 - 120	19.0	23	120	86	17	-	1.5	G2B-2CC	CCGT040102	3	
	BCA19 - 180	19.0	23	180	86	17	44	2.0				
	BT40	BCA23 - 135	23.0	29	135	92	20	-	1.5	G3B-2TC	TBGT060104	1
		BCA23 - 195	23.0	29	195	102	20	50	2.0			3
		BCA29 - 150	29.0	41	150	108	25	28	1.5	G3A-2TC	TBGT060104	2
		BCA29 - 195	29.0	41	195	113	25	50	2.0			3
		BCA38 - 150	38.0	49	150	115	36	37	1.7	G5B-2TC	TCMT110204	2
		BCA38 - 195	38.0	49	195	155	36	50	2.2			
		BCA46 - 150	46.0	66	150	118	38	40	2.1	G5A-2TC	TCMT110204	2
		BCA46 - 210	46.0	66	210	165	38	50	2.8			
		BCA62 - 165	62.0	87	165	135	51	50	3.0	G7A-2TC	TCMT16T304	4
		BCA62 - 225	62.0	87	225	198	51	62	4.5			
	BCA83 - 150	83.0	108	150	123	63	61	3.5	G7A-2TC	TCMT16T304	4	
BCA83 - 225	83.0	108	225	198	63	61	6.0					
BCA98 - 150	98.0	142	150	123	75	60	5.0	G10A-2TC	TCMT16T304	4		

MICRO BORING BAR 微调镗孔刀柄

MAS403 BT-BCA

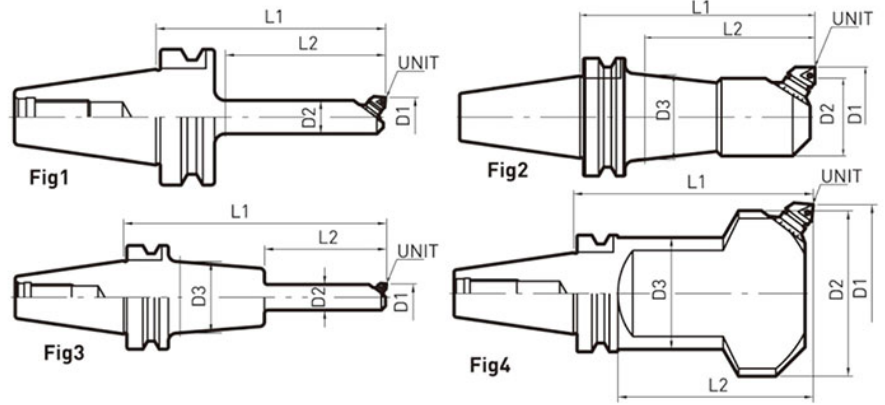

锥体 Taper AT3 mm

CODE NO.	D1		L1	L2	D2	D3	WEIGHT (Kg)	UNIT	INSERT	FIG
	min.	max.								
BCA13.5 - 120	13.5	15.9	120	67	13	35	4.0	M1B2F-40	-	3
BCA13.5 - 195	13.5	15.9	195	67	13	50	5.0			
BCA14.5 - 120	14.5	16.9	120	68	14	35	4.0	M1B2E-40	-	3
BCA14.5 - 195	14.5	16.9	195	68	14	50	5.0			
BCA16.5 - 120	16.5	21.9	120	73	15.5	40	4.0	M1B2F-40	-	3
BCA16.5 - 195	16.5	21.9	195	73	15.5	55	5.0			
BCA19 - 135	19	23	135	81	17.5	18	4.0	G2B-2TC	CCGT040102	3
BCA19 - 210	19	23	210	81	17.5	55	4.5			
BCA23 - 135	23	29	135	92	20	-	4.0	G3B-2TC	TBGT060104	1
BCA23 - 210	23	29	210	102	20	55	5.0			3
BCA29 - 150	29	41	150	112	25	28	4.5	G3A-2TC	TBGT060104	3
BCA29 - 225	29	41	225	112	25	55	5.5			
BCA38 - 165	38	49	165	122	36	37	4.5	G5B-2TC	TCMT110204	2
BCA38 - 225	38	49	225	167	36	36	5.0			
BCA46 - 165	46	66	165	122	38	45	5.0	G5A-2TC	TCMT110204	2
BCA46 - 225	46	66	225	182	38	45	5.5			
BCA46 - 255	46	66	255	202	38	46	6.0	G7A-2TC	TCMT16T304	2
BCA62 - 180	62	87	180	137	51	59	6.0			
BCA62 - 240	62	87	240	181	51	59	7.0	G7A-2TC	TCMT16T304	2
BCA62 - 330	62	87	330	277	51	59	8.5			
BCA83 - 165	83	108	165	122	63	76	6.5			
BCA83 - 240	83	108	240	197	63	76	9.0	G10A-2TC	TCMT16T304	2
BCA83 - 345	83	108	345	293	63	76	12.0			
BCA98 - 165	98	142	165	122	83	79	8.5			
BCA98 - 240	98	142	240	200	83	92	11.5	G10A-2TC	TCMT16T304	4
BCA98 - 345	98	142	345	305	83	92	17.0			
BCA132 - 210	132	176	210	172	110	96	12.0			
BCA132 - 315	132	176	315	277	110	96	18.5	G10A-2TC	TCMT16T304	4
BCA166 - 225	166	210	225	187	145	96	13.0			
BCA166 - 315	166	210	315	277	145	96	18.5			
BCA200 - 210	200	244	210	172	178	98	20.0			

BT50

MICRO BORING BAR(Straight type) 微调镗孔刀柄 (直型设计)

K-BCA



· K20:60
K32, K42:100

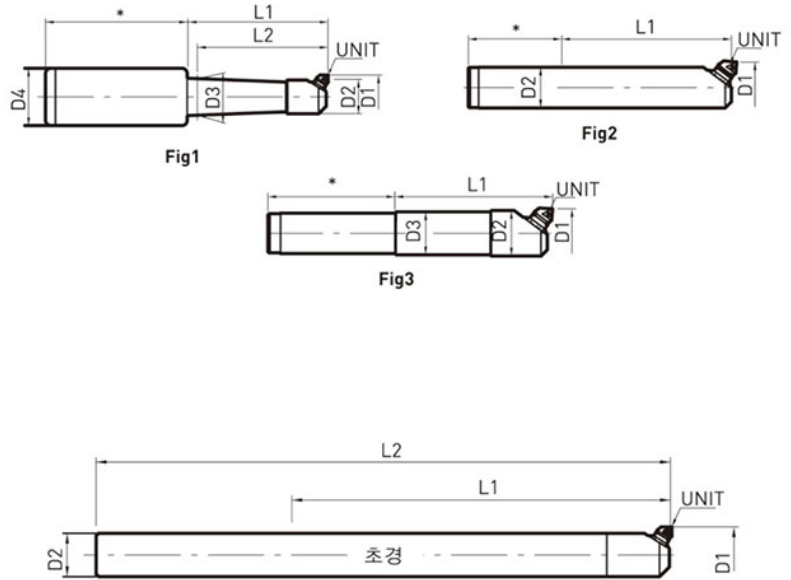

CODE NO.	D1		L1	L2	D2	D3	UNIT	INSERT	FIG					
	MIN.	MAX.												
K20	BCA13.5 - 75	13.5	15.9	75	67	13.0	13.0	M1B2F-40	----	3				
	BCA14.5 - 75	14.5	16.9			14.0	14.0	M1B2E-40						
	BCA16.5 - 90	16.5	18.0	90	89	15.5	16	M1A2F-40						
	BCA19 - 90	19.0	23			17	17.5	G2B-2CC			CCGT040102			
	BCA23 - 120	23.0	29	120	-	20.0	19	G3B-2TC			TCGT060204	2		
	BCA29 - 120	29.0	41			27.0	26.0	G3A-2TC			TCGT060204	3		
K32	BCA13.5 - 75	13.5	15.9	75	67	13.0	13.0	M1B2F-40	----	3				
	BCA14.5 - 75	14.5	16.9			14.0	14.0	M1B2E-40						
	BCA16.5 - 90	16.5	18.0	90	88	15.5	16.0	M1A2F-40						
	BCA19 - 90	19.0	23			17.5	18.0	G2B-2CC			CCGT040102			
	BCA23 - 120	23.0	29	120	105	20	19	G3B-2TC			TBGT060104	2		
	BCA29 - 120	29.0	41			-	27	26				G3A-2TC	3	
	BCA38 - 120	38.0	49			-	36	34				G5B-2TC	TCMT110204	3
	BCA46 - 120	46.0	66				38.0	36				G5A-2TC		
BCA62 - 120	62.0	87	-	51.0	40	G7A-2TC	TCMT16T304							
K42	BCA13.5 - 75	13.5	15.9	75	67	13.0	13.0	M1B2F-40	----	3				
	BCA14.5 - 75	14.5	16.9			14.0	14.0	M1B2E-40						
	BCA16.5 - 90	16.5	18.0	90	87	15.5	20	M1A2F-40						
	BCA19 - 90	19.0	23			17.5	18.0	G2B-2CC			CCGT040102			
	BCA23 - 120	23.0	29	120	105	20	19	G3B-2TC			TBGT060104	2		
	BCA29 - 120	29.0	41			-	27	26				G3A-2TC		
	BCA38 - 120	38.0	49			-	36	34				G5B-2TC	TCMT110204	3
	BCA46 - 120	46.0	66				38.0	36				G5A-2TC		
	BCA62 - 120	62.0	87	-	51.0	40	G7A-2TC	TCMT16T0304						

mm

SQUARE BORING BAR 直角型镗刀柄

MAS403 BT-BSA

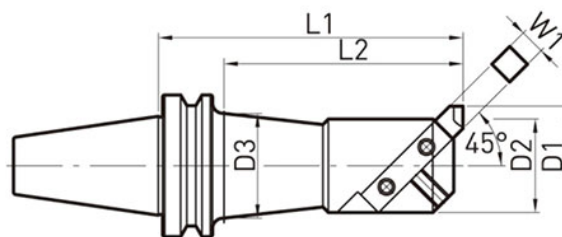

Fig1

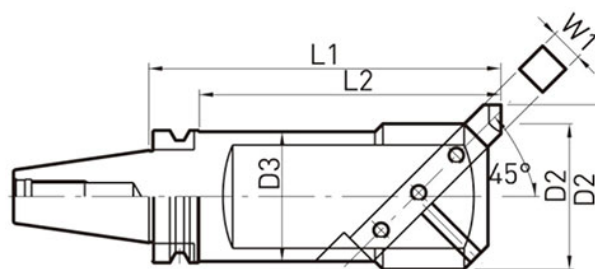

Fig2

NOTE 注意

.Square Bolt (完成 Bolt)产品出库时，不为组装完成的。
 即我司不生产Square Bolt 因此不供应Square Bolt。
 · Square Bolt is out of our product range and we do not selling Square Bolt.

锥体 Taper AT3 mm

CODE NO.	D1		L1	L2	D2	D3	W1	WEIGHT (Kg)	FIG	
	MIN.	MAX.								
BT40	BSA 25 - 135	25	38	135	105	20	23	8	1.4	1
	BSA 30 - 150	30	42	150	120	24	27		1.4	
	BSA 38 - 165	38	52	165	135	30	34	10	1.7	
	BSA 42 - 165	42	56			34	38		1.8	
	BSA 50 - 165	50	65	165	135	40	45	13	2.3	
	BSA 50 - 210			210	180	3.1				
	BSA 62 - 180	62	90	180	151	50	57	16	3.4	
	BSA 62 - 225			225	196				4.6	
	BSA 72 - 180	72	110	180	153	60	60	19	3.9	
	BSA 72 - 225			225	198				5.0	
BSA 90 - 180	90	125	180	153	75	60	19	5.2		
BSA 90 - 225			225	198				6.2		
BT50	BSA 25 - 135	25	38	135	92	20	23	8	4.2	2
	BSA 30 - 165	30	42	165	122	24	27		4.4	
	BSA 38 - 180	38	52	180	137	30	34	10	4.8	
	BSA 42 - 210	42	56	210	167	34	38		5.0	
	BSA 50 - 180	50	65	180	137	40	45	13	5.4	
	BSA 50 - 240			240	197				5.7	
	BSA 62 - 195	62	90	195	152	50	57	16	6.2	
	BSA 62 - 270			270	227				7.6	
	BSA 72 - 195	72	110	195	152	60	67	19	7.0	
	BSA 72 - 285			285	242				9.3	
	BSA 90 - 210	90	125	210	167	75	81	19	9.2	
	BSA 90 - 300			300	257				12.3	
	BSA105 - 195	105	160	195	154	90	90	25	10.7	
BSA105 - 285	285			244	94		15.0			
BSA130 - 255	130	190	255	217	110	98	25	14.5		

SQUARE BORING BAR 直角型镗刀柄

MAS403 BT-BSB

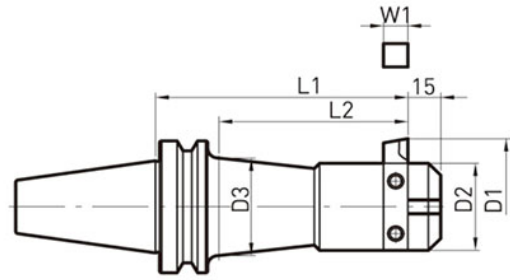

Fig1

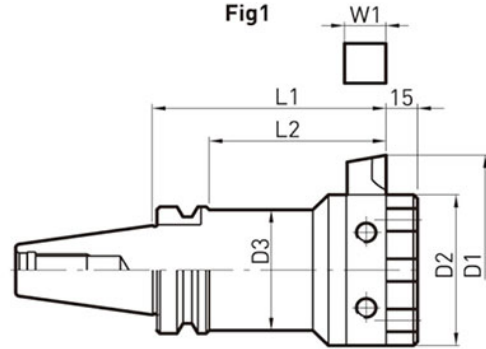

Fig2

NOTE 注意

Square Bolt (完成 Bolt)产品出库时, 不为组装完成的。
即我司不生产Square Bolt 因此不供应Square Bolt。
· Square Bolt is out of our product range and we do not selling Square Bolt.

锥体 Taper AT3 mm

CODE NO.	D1		L1	L2	D2	D3	W1	WEIGHT (Kg)	FIG	
	MIN.	MAX.								
BT40	BSB 25 - 135	25	52	135	103	20	22	8	1.6	1
	BSB 38 - 165	38	70	165	133	30	32	10	1.9	
	BSB 50 - 165	50	90	165	135	40	44	13	2.5	
	BSB 50 - 210	50	90	210	180	40	44	13	3.3	
	BSB 62 - 180	62	115	180	152	50	56	16	3.6	
	BSB 62 - 225	62	115	225	197	50	56	16	4.8	
	BSB 72 - 180	72	135	180	153	60	60	19	4.1	
	BSB 72 - 225	72	135	225	198	60	60	19	5.2	
	BSB 90 - 180	90	150	180	153	75	60	19	5.4	
BSB 90 - 225	90	150	225	198	75	60	19	6.4		
BT50	BSB 25 - 135	25	52	135	92	20	22	8	4.4	1
	BSB 38 - 180	38	70	180	137	30	32	10	5.0	
	BSB 50 - 180	50	90	180	137	40	44	13	5.6	
	BSB 50 - 240	50	90	240	197	40	44	13	5.9	
	BSB 62 - 195	62	115	195	152	50	56	16	6.4	
	BSB 62 - 270	62	115	270	227	50	56	16	7.8	
	BSB 72 - 195	72	135	195	152	60	66	19	7.2	
	BSB 72 - 285	72	135	285	242	60	66	19	9.5	
	BSB 90 - 210	90	150	210	167	75	80	19	9.4	
	BSB 90 - 300	90	150	300	257	75	80	19	12.5	
	BSB105 - 195	105	190	195	155	90	94	25	10.9	
BSB105 - 285	105	190	285	245	90	94	25	15.2		
BSB130 - 255	130	260	255	217	110	98	25	14.7		

标准镗刀系列 MODULAR BORING SYSTEM



Clamp System 夹紧系统

· 韩国第一机械 的锁紧系统与其他任何方法相比通过更有力地
将 Head和Holder 连接,有效地实现无振动高精度加工。

· A Locking system of Jeil's boring system combine the boring head
with basic holder so that improving boring accuracy without vibration.

超强力型 Boring Head / Strong Boring Head

· 使用特殊工具钢, 维持80~90/mm的硬性, DOVETAIL 式构造为重切削
镗孔中最好的。

· Our boring head keep strongness 80~90kg/mm by using special
raw-material and it is proper to heavy cutting boring by Dovetail design.

简便精确的数值调整

Easy and accuracy adjusting of boring range

(SYNCRONIZED ADJUSTMENT)

· 具有单刀刃的微调整装置, 通过内部设置可精确的吻合Insert Nose R 的
误差,在加工时小化对头部阻力,从而延长镗刀头的寿命。

· Accuracy adjusting of tolerance of insert nose R by single blade so
that it minimize a resistance which effect to the the boring head when
machining.

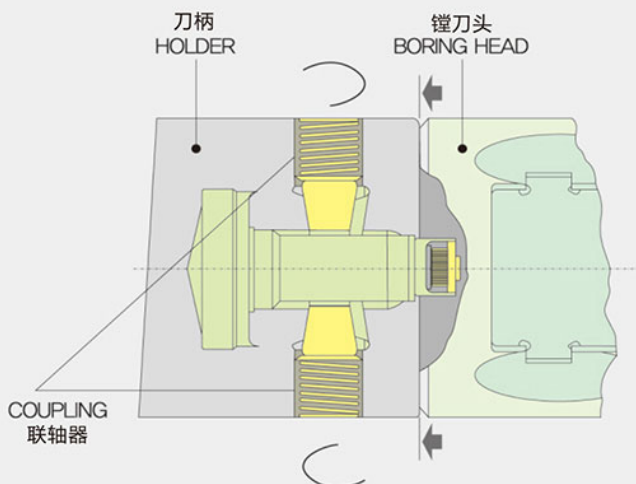

BORING HEAD A'SSY 镗刀头A'SSY

镗刀头 构造图 Explanatory Diagram of Boring Head

FINISHING BORING HEAD

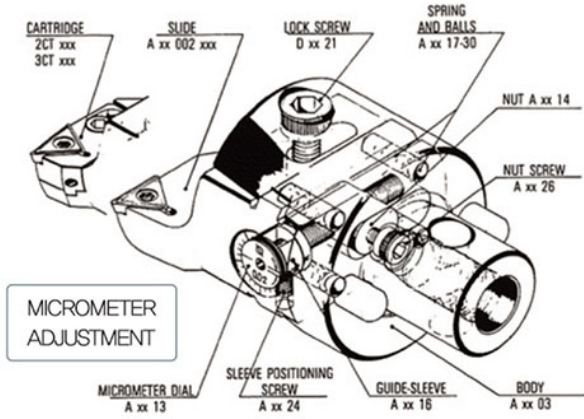

RARGE SIZE FINISHING BORING HEAD

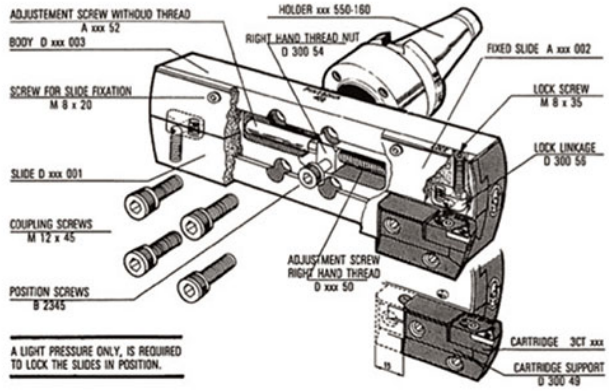

BORING HEAD SELECTION 镗刀头 选择

镗刀头 选择方法 Explanatory Diagram of Boring Head selection

FINISHING BORING HEAD

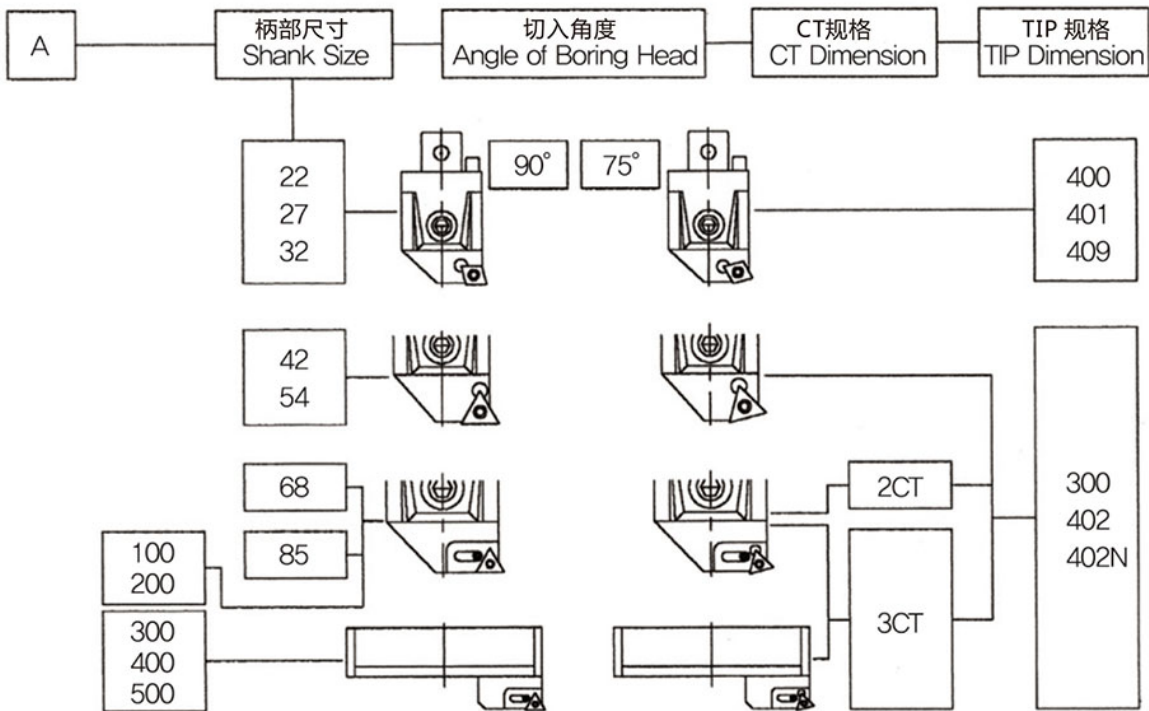

BORING HEAD 镗刀头

A 精镗头
FINISHING BORING HEAD

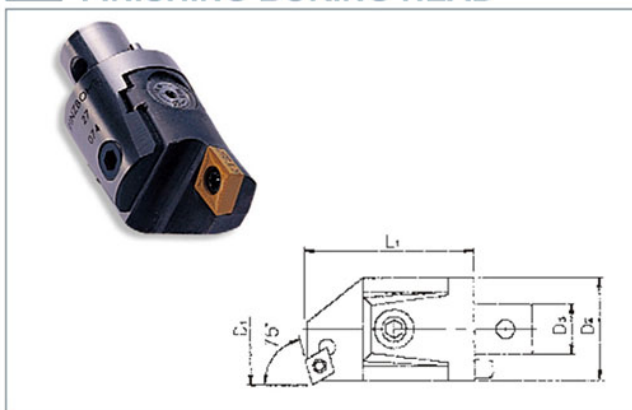

D 粗镗头
ROUGHING BORING HEAD

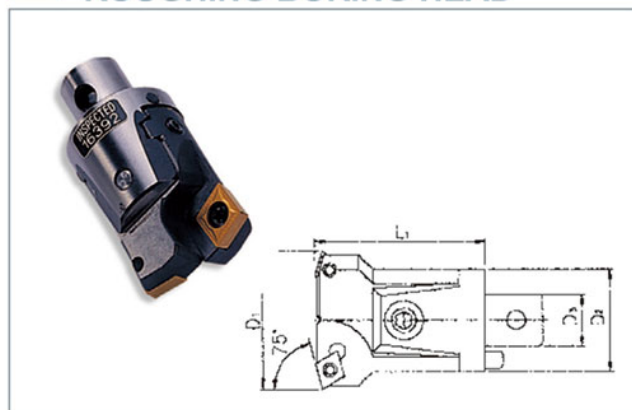

CODE NO	D ₁		D ₂	D ₃	L ₁	Kg	INSERT	INSERT SCREW
	MIN.	MAX.						
A 2275 400	24	30	22	12	34	0.08	CC..0602..	M2.5 × 5.6
A 2775 409	29	40	27	15	42	0.18	CC..09T3..	M4 × 10
A 3275 409	39	50	32	20	45	0.25	CC..09T3..	M4 × 10
D 2275 400	24	30	22	12	34	0.10	CC..0602..	M2.5 × 5.6
D 2775 409	29	40	27	15	42	0.18	CC..09T3..	M4 × 10
D 3275 409	39	50	32	20	45	0.26	CC..09T3..	M4 × 10

A 精镗头
FINISHING BORING HEAD

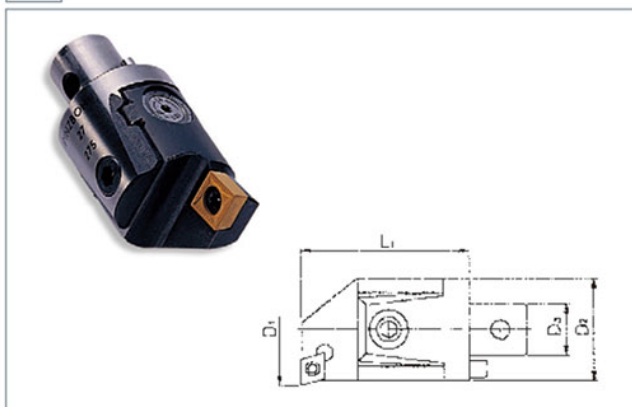

D 粗镗头
ROUGHING BORING HEAD

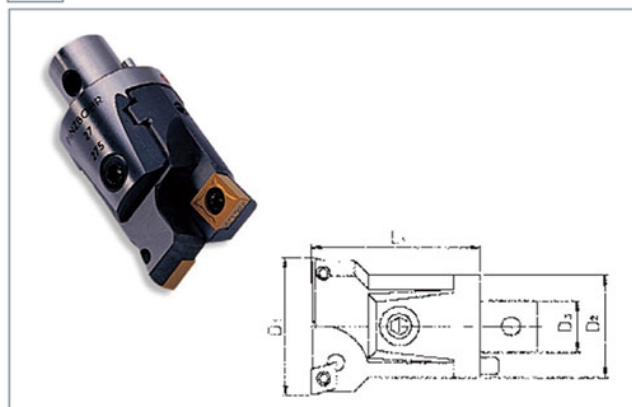

CODE NO	D ₁		D ₂	D ₃	L ₁	Kg	INSERT	INSERT SCREW
	MIN.	MAX.						
A 2290 400	24	30	22	12	34	0.08	CC..0602..	M 2.5 × 5.6
A 2790 409	29	40	27	15	42	0.18	CC..09T3..	M 4 × 10
A 3290 409	39	50	32	20	45	0.25	CC..09T3..	M 4 × 10
D 2290 400	24	30	22	12	34	0.10	CC..0602..	M 2.5 × 5.6
D 2790 409	29	40	27	15	42	0.18	CC..09T3..	M 4 × 10
D 3290 409	39	50	32	20	45	0.26	CC..09T3..	M 4 × 10

BORING HEAD 镗刀头

A 精镗头
FINISHING BORING HEAD

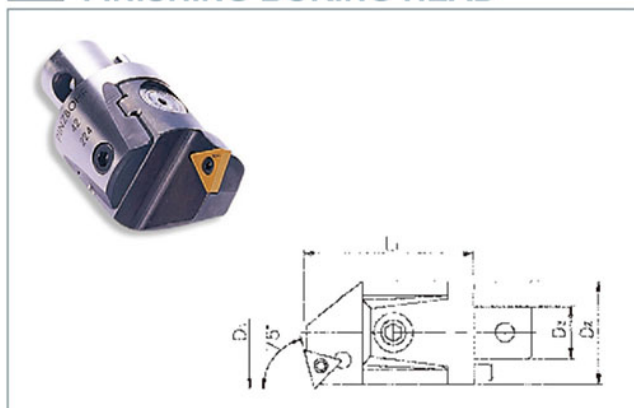

D 粗镗头
ROUGHING BORING HEAD

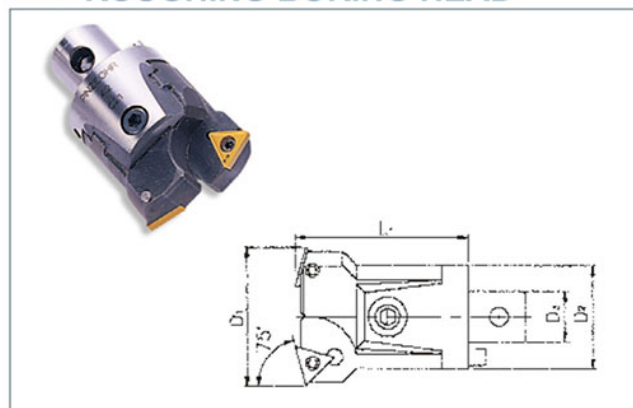

CODE NO	D ₁		D ₂	D ₃	L ₁	Kg	INSERT	INSERT SCREW
	MIN.	MAX.						
A 4275 300	49	65	42	24	56	0.58	TC..16T3..	M 4 × 10
A 5475 300	63	82	54	28	66	1.05	TC..16T3..	M 4 × 10
D 4275 300	49	65	42	24	56	0.6	TC..16T3..	M 4 × 10
D 4275 402	49	65	42	24	56	0.6	CC..1204..	M 5 × 13.1
D 5475 300	63	82	54	28	66	1.1	TC..16T3..	M 4 × 10
D 5475 402	63	82	54	28	66	1.1	CC..1204..	M 5 × 13.1

A 精镗头
FINISHING BORING HEAD

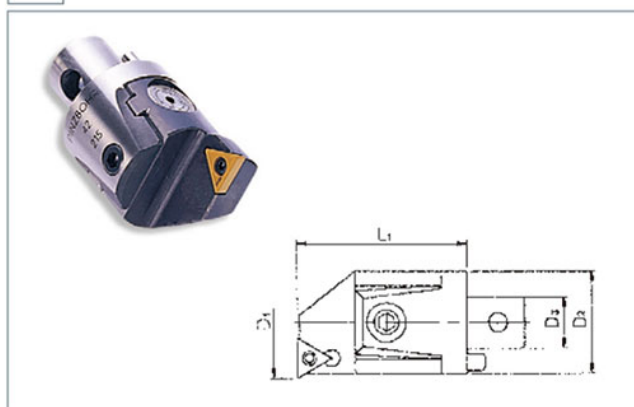

D 粗镗头
ROUGHING BORING HEAD

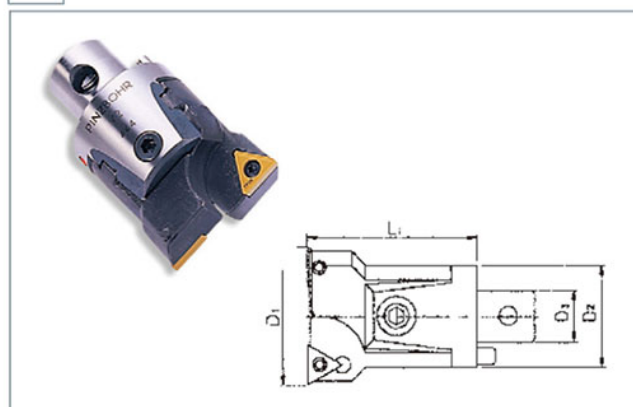

CODE NO	D ₁		D ₂	D ₃	L ₁	Kg	INSERT	INSERT SCREW
	MIN.	MAX.						
A 4290 300	49	65	42	24	56	0.58	TC..16T3..	M 4 × 10
A 5490 300	63	82	54	28	66	1.05	TC..16T3..	M 4 × 10
D 4290 300	49	65	42	24	56	0.6	TC..16T3..	M 4 × 10
D 4290 402	49	65	42	24	56	0.6	CC..1204..	M 5 × 13.1
D 5490 300	63	82	54	28	66	1.1	TC..16T3..	M 4 × 10
D 5490 402	63	82	54	28	66	1.1	CC..1204..	M 5 × 13.1

BORING HEAD 镗刀头

보링헤드

A 精镗头 FINISHING BORING HEAD

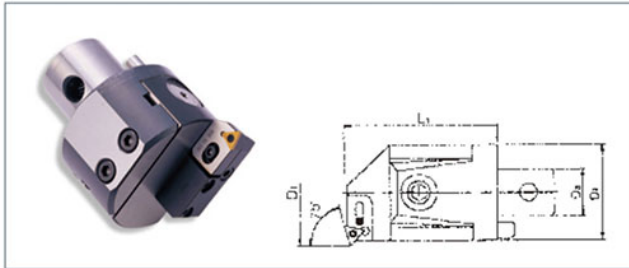

D 粗镗头 ROUGHING BORING HEAD

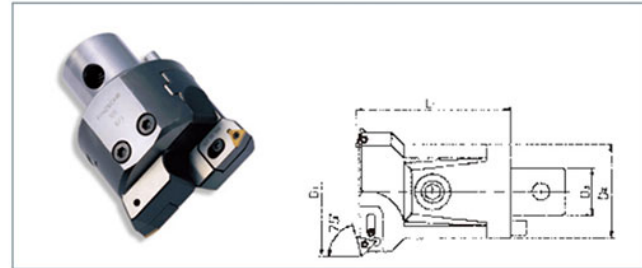

CODE NO	D ₁		D ₂	D ₃	L ₁	Kg	INSERT	CARTRIDGES
	MIN.	MAX.						
A 6875 2CT 300	80	102	68	36	86	2.18	TC..16T3..	2CT 75 300
A 8575 3CT 300	100	125	85	50	100	4.2	TC..16T3..	3CT 75 300
A 10075 3CT 300	125	160	100	60	100	6.6		
A 20075 3CT 300	160	220	145	60	100	8.96		
D 6875 2CT ...	80	102	68	36	86	2.3	TC..16T3.. CC..1204..	2CT 75 300 2CT 75 402
D 8575 3CT ...	100	125	85	50	100	4.3	TC..16T3.. CC..1204..	3CT 75 300 3CT 75 402
D 10075 3CT ...	125	160	100	60	100	6.8		
D 20075 3CT ...	160	220	145	60	100	9.0		

A 精镗头 FINISHING BORING HEAD

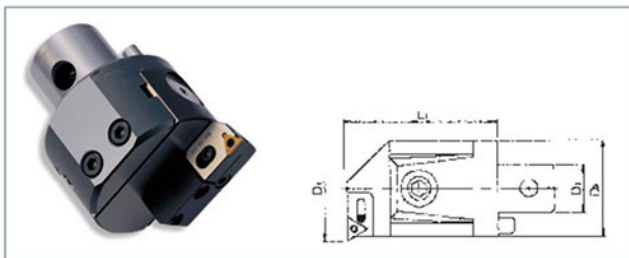

D 粗镗头 ROUGHING BORING HEAD

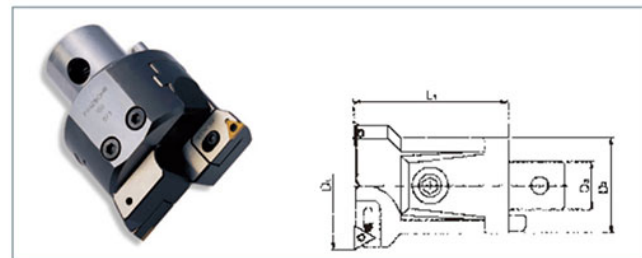

CODE NO	D ₁		D ₂	D ₃	L ₁	Kg	INSERT	CARTRIDGES
	MIN.	MAX.						
A 6890 2CT ...	80	102	68	36	86	2.18	TC..16T3.. CC..1204..	2CT 90 300 2CT 90 402
A 8590 3CT ...	100	125	85	50	100	4.2	TC..16T3.. CC..1204..	3CT 90 300 3CT 90 402
A 10090 3CT ...	125	160	100	60	100	6.6		
A 20090 3CT ...	160	220	145	60	100	8.96		
D 6890 2CT ...	80	102	68	36	86	2.3	TC..16T3.. CC..1204..	2CT 90 300 2CT 90 402
D 8590 3CT ...	100	125	85	50	100	4.3	TC..16T3.. CC..1204..	3CT 90 300 3CT 90 402
D 10090 3CT ...	125	160	100	60	100	6.8		
D 20090 3CT ...	160	220	145	60	100	9.0		

RARGE SIZE BORING HEAD 大径用 镗刀头

A 精镗头
FINISHING BORING HEAD

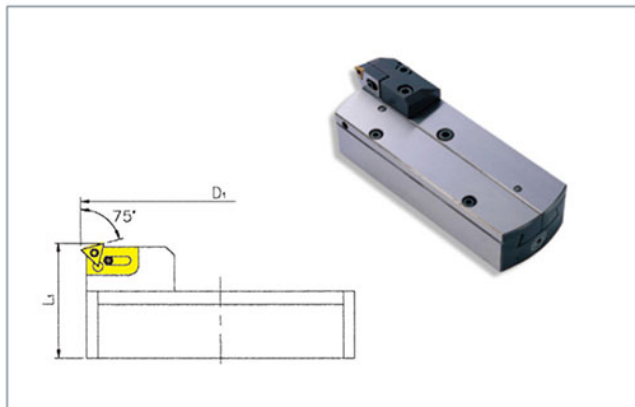

D 粗镗头
ROUGHING BORING HEAD

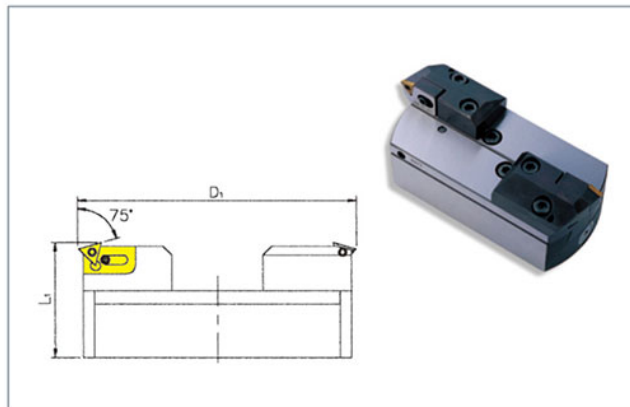

CODE NO	D ₁		L ₁	Kg	INSERT	CARTRIDGES
	MIN.	MAX.				
A 30075 3CT 300	220	320	90	9.3	TC..16T3..	3CT 75 300
A 40075 3CT 300	290	400	90	12.85		
A 50075 3CT 300	370	500	90	16.25		
D 30075 3CT ...	220	320	90	10.1	TC..16T3.. CC..1204..	3CT 75 300 3CT 75 402
D 40075 3CT ...	290	400	90	13.75		
D 50075 3CT ...	370	500	90	16.95		

A 精镗头
FINISHING BORING HEAD

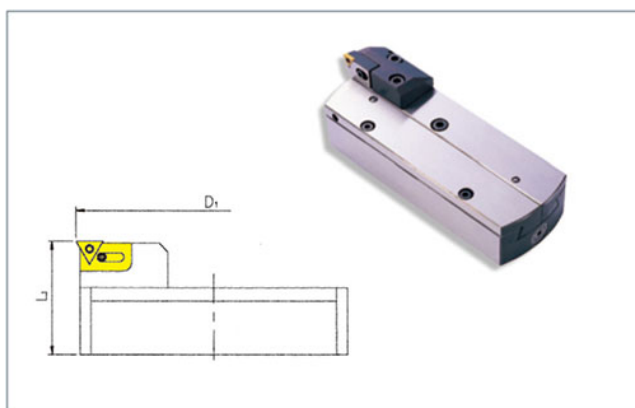

D 粗镗头
ROUGHING BORING HEAD

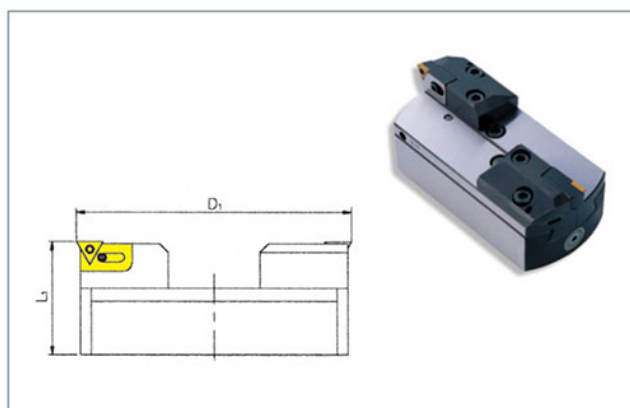

CODE NO	D ₁		L ₁	Kg	INSERT	CARTRIDGES
	MIN.	MAX.				
A 30090 3CT ...	220	320	90	9.3	TC..16T3.. CC..1204..	3CT 90 300 3CT 90 402
A 40090 3CT ...	290	400	90	12.85		
A 50090 3CT ...	370	500	90	16.25		
D 30090 3CT ...	220	320	90	10.1	TC..16T3.. CC..1204..	3CT 90 300 3CT 90 402
D 40090 3CT ...	290	400	90	13.75		
D 50090 3CT ...	370	500	90	16.95		

ROUGHING BORING HEAD 粗镗头

RBH (ROUGHING BORING HEAD)

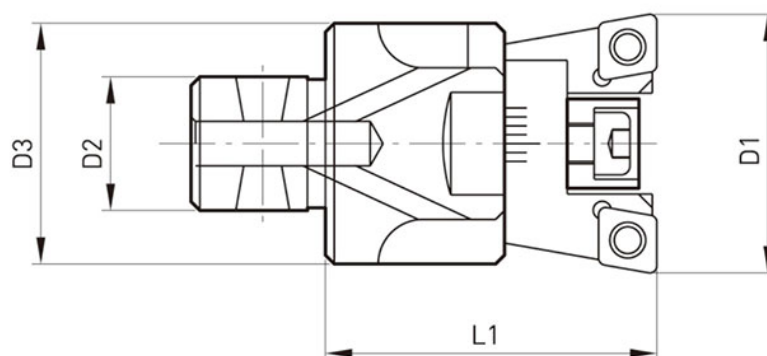

CODE NO.	D1		D2	D3	L1	Kg	INSERT	BASIC HOLDER
	MIN.	MAX.						
RBH29	29	38	15	27	37	0.07	CC..0602..	BH2715
RBH38	38	48	20	32	40	0.16	CC..0602..	BH3220
RBH48	48	60	24	42	54	0.23	CC..09T3..	BH4224
RBH60	60	75	28	54	67	0.40	CC..1204..	BH5428
RBH75	75	100	36	68	70	0.76	CC..1204..	BH6836
RBH100	100	130	50	85	75	1.80	CC..1204..	BH8550
RBH130	130	180	60	100	86	5.5	CC..1204..	BH10060

ROUGHING BORING HEAD 粗镗头

MAS403 BT-RBH

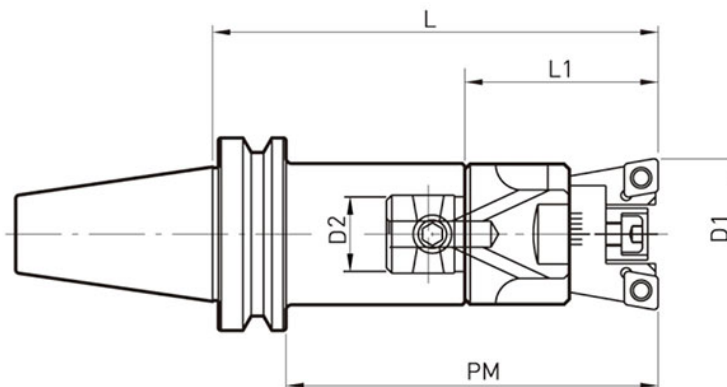

锥体 Taper AT3 mm

CODE NO.	D1		PM	L	L1	BASIC HOLDER	WEIGHT (Kg)	
	MIN.	MAX.						
BT40	RBH 29 - 142	29	38	115	142	37	BT40-27 - 130	1.60
	RBH 38 - 152	38	48	125	152	40	BT40-32 - 130	1.70
	RBH 48 - 185	48	60	158	185	54	BT40-42 - 160	2.40
	RBH 60 - 188	60	75	161	188	67	BT40-54 - 160	2.90
	RBH 75 - 211	75	100	184	211	70	BT40-68 - 200	4.00
BT50	RBH 29 - 133	29	38	95	133	37	BT50-27 - 100	4.50
	RBH 29 - 163			125	163		BT50-27 - 130	4.60
	RBH 38 - 163	38	48	125	163	40	BT50-32 - 130	4.70
	RBH 38 - 193			155	193		BT50-32 - 160	4.90
	RBH 48 - 196	48	60	158	196	54	BT50-42 - 160	5.50
	RBH 48 - 236			198	236		BT50-42 - 200	6.00
	RBH 60 - 199	60	75	161	199	67	BT50-54 - 160	6.20
	RBH 60 - 239			201	239		BT50-54 - 200	6.90
	RBH 75 - 222	75	100	184	222	70	BT50-68 - 200	7.60
	RBH 75 - 282			244	282		BT50-68 - 260	9.00
	RBH100 - 213	100	130	175	213	75	BT50-85 - 200	14.40
	RBH100 - 273			235	273		BT50-85 - 260	16.00
	RBH130 - 284	130	180	246	284	86	BT50-100-260	13.00
	RBH130 - 344			306	344		BT50-100-320	18.00

BASIC HOLDER 基础刀柄

BH

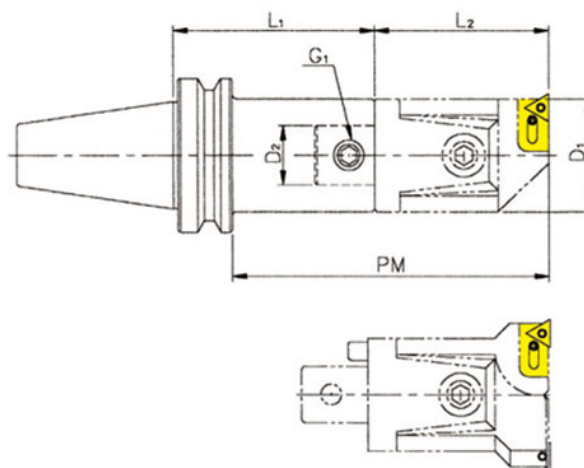

锥体 Taper AT3 mm

CODE NO		D ₁	D ₂	PM	L ₁	L ₂	WEIGHT (Kg)	G ₁ (ARBOR SCREW)
BT30	22 100	22	12	100	88	34	0.58	22 - 68
	27 55	27	15	55	35	42	0.45	27 - 610
	27 100	27	15	100	80	42	0.64	27 - 610
	32 60	32	20	60	37	45	0.45	32 - 810
	32 100	32	20	100	77	45	0.69	32 - 810
BT40	22 50	22	12	50	43	34	1.20	22 - 68
	22 80	22	12	80	73	34	1.30	22 - 68
	22 100	22	12	100	93	34	1.40	22 - 68
	27 55	27	15	55	40	42	1.20	27 - 610
	27 100	27	15	100	85	42	1.45	27 - 610
	27 130	27	15	130	115	42	1.60	27 - 610
	32 60	32	20	60	42	45	1.20	32 - 810
	32 100	32	20	100	82	45	1.47	32 - 810
	32 130	32	20	130	112	45	1.70	32 - 810
	42 75	42	24	75	46	56	1.30	42 - 1014
	42 160	42	24	160	131	56	2.25	42 - 1014
	42 200	42	24	200	171	56	2.75	42 - 1014
	54 90	54	28	90	51	66	1.80	54 - 1220
	54 160	54	28	160	121	66	2.80	54 - 1220
	54 200	54	28	200	161	66	3.55	54 - 1220
68 160	68	36	160	101	86	2.80	68 - 1624	
68 200	68	36	200	141	86	3.90	68 - 1624	

BASIC HOLDER 基础刀柄

BH

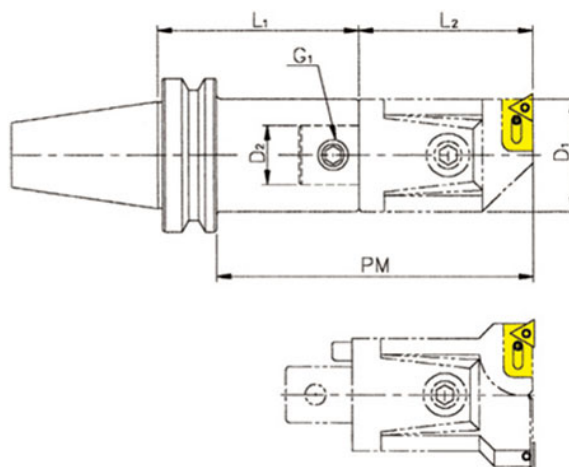

- 以下蓝色圈标志的刀柄，刀头200以下用
- Marks are for below 200mm boring head

锥体 Taper AT3 mm

CODE NO	D ₁	D ₂	PM	L ₁	L ₂	WEIGHT (kg)	G ₁ (ARBOR SCREW)
22 80	22	12	80	84	34	4.20	22 - 68
22 100	22	12	100	104	34	4.35	22 - 68
27 55	27	15	55	51	42	4.05	27 - 610
27 100	27	15	100	96	42	4.40	27 - 610
27 130	27	15	130	126	42	4.50	27 - 610
32 60	32	20	60	53	45	3.95	32 - 810
32 130	32	20	130	123	45	4.60	32 - 810
32 160	32	20	160	153	45	4.80	32 - 810
42 75	42	24	75	57	56	4.15	42 - 1014
42 160	42	24	160	142	56	5.20	42 - 1014
42 200	42	24	200	182	56	5.80	42 - 1014
54 90	54	28	90	62	66	4.80	54 - 1220
54 160	54	28	160	132	66	5.80	54 - 1220
54 200	54	28	200	172	66	6.50	54 - 1220
68 115	68	36	115	67	86	4.45	68 - 1624
68 200	68	36	200	152	86	7.20	68 - 1624
68 260	68	36	260	212	86	8.85	68 - 1624
85 200	85	50	200	138	100	7.85	85 - 1630
85 260	85	50	260	198	100	10.65	85 - 1630
85 320	85	50	320	258	100	13.40	85 - 1630
● 100 170	100	60	170	108	100	6.15	100 - 2035
● 100 260	100	60	260	198	100	12.85	100 - 2035
● 100 320	100	60	320	258	100	16.50	100 - 2035

BT50

BASIC HOLDER 直线型 镗孔刀柄

K-32

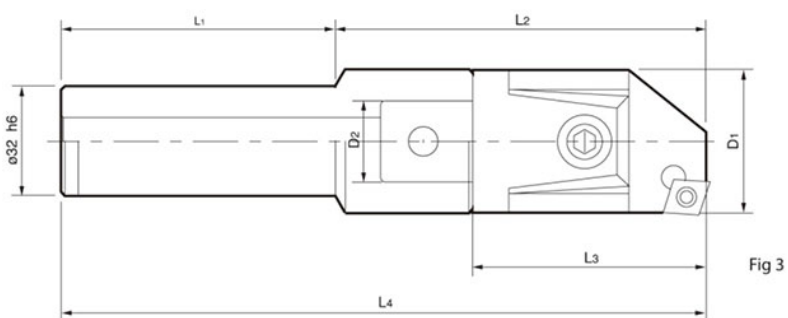
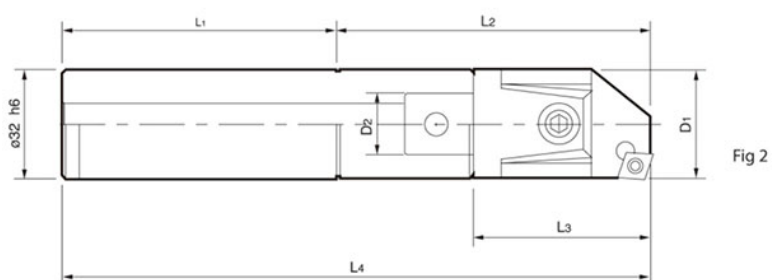
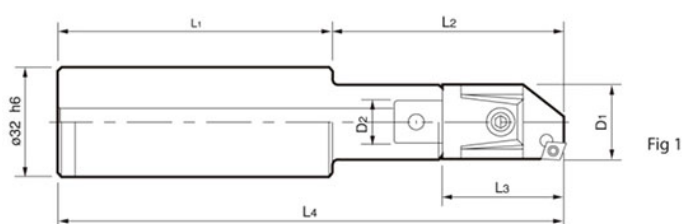

CODE NO		D ₁	D ₂	L ₁	L ₂	L ₃	L ₄	SCREW	Fig
K 32	22 66	22	12	80	66	34	146	22 - 68	1
	27 81	27	15		81	42	161	27 - 610	
	32 85	32	20		85	45	165	32 - 810	2
	42 96	42	24		96	56	176	42 - 1014	3
	54 106	54	28		106	66	186	54 - 1220	

mm

LARGE SIZE ARBOR 大径用刀柄

直附型

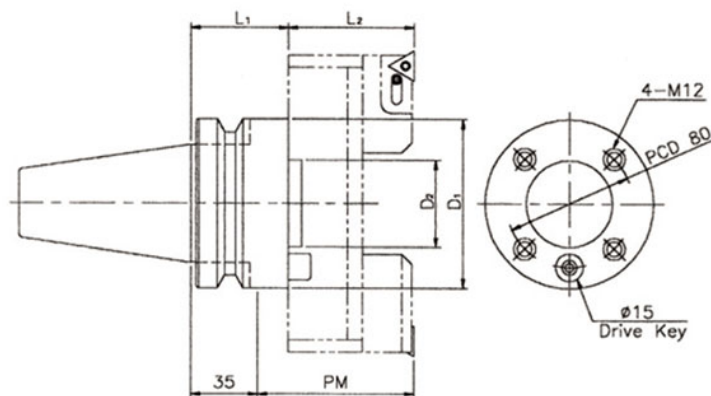

A300. 400. 500

mm

CODE NO	D ₁	D ₂	PM	L ₁	L ₂	WEIGHT (Kg)	HEAD SCREW
BT550 160	100	60	125	70	90	6.25	M 12 x 45

LARGE SIZE ADAPTER 大径用适配装置

适配装置贴附型

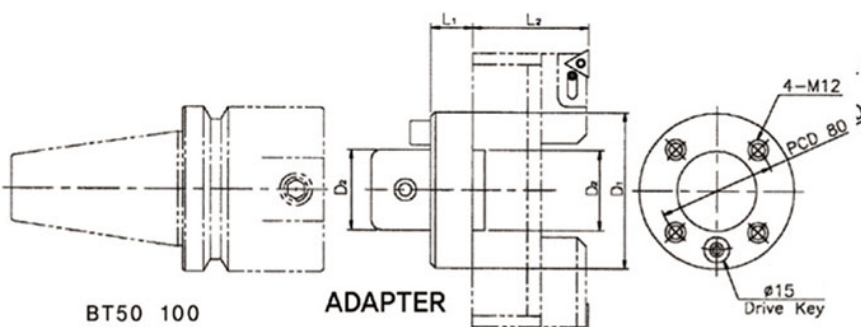

A300. 400. 500
D300. 400. 500

mm

CODE NO	D ₁	D ₂	L ₁	L ₂	WEIGHT (Kg)	HEAD SCREW
ADT 100 - 50	100	60	50	90	4.6	M 12 x 45

EXTENSION PIECE 加长接头

P

EXTENSION PIECE 利用加长接头增加长度的方法
(How to extend the length of boring arbor)

$$PM1 = (L1 - \text{BT FLANGE 厚度}) + L3 + L2$$

PINZBOHR ARBOR 可通过增加延长接头来延长长度。
但由于刀柄出现抖动现象，所以不建议增加1个以上连接头。

T FLANGE 厚度 (Thickness of BT flange)

- BT30 = 22
- BT40 = 27
- BT50 = 38

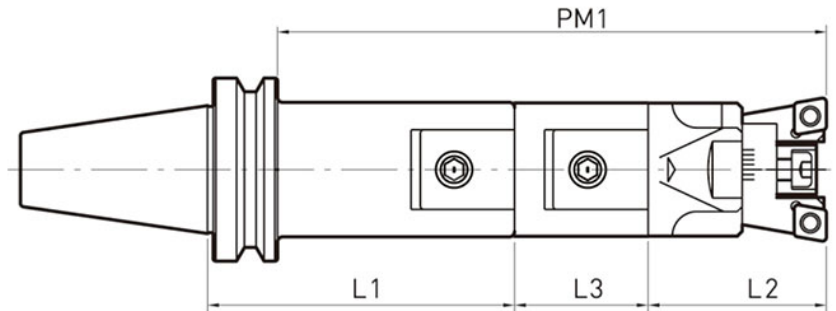

ARBOR 刀柄 连接头 EXTENSION PIECE 刀头 HEAD

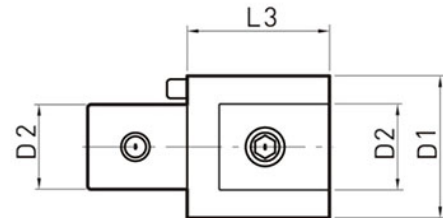

mm

CODE NO.	D1	D2	L3	WEIGHT (Kg)	SCREW
P 22 20	22	12	20	0.095	22-68
P 22 30			30	0.140	
P 27 30	27	15	30	0.180	27-610
P 27 45			45	0.250	
P 32 35	32	20	35	0.260	32-810
P 32 52			52	0.375	
P 42 40	42	24	40	0.480	42-1014
P 42 60			60	0.700	
P 54 50	54	28	50	0.950	54-1220
P 54 75			75	1.400	
P 68 60	68	36	60	1.800	68-1624
P 68 90			90	2.600	
P 85 70	85	50	70	3.050	85-1630
P 85 105			105	4.450	
P 100 80	100	60	80	4.600	100-2035
P 100 120			120	7.100	

ADVANCING PRODUCTIVITY

— 致力于生产效率提高的海纳 —

**我们对于服务的重视，远高于业务；
我们对于质量的要求，远高于数量。**

本公司善于改良机具，增强品质效益。
本团队勇于终身学习，追求卓越完美。

精益求精，制造性能及质量稳定性上媲美欧美日韩产品，
为客户取得更大的经济效益。

坚持工匠精神，精雕细琢，采用现代化管理手段，注重产
品的每一个细节，保证每件产品质量及稳定性。

